

# **CHILDREN'S ELECTRIC TOY CAR**

With remote control function

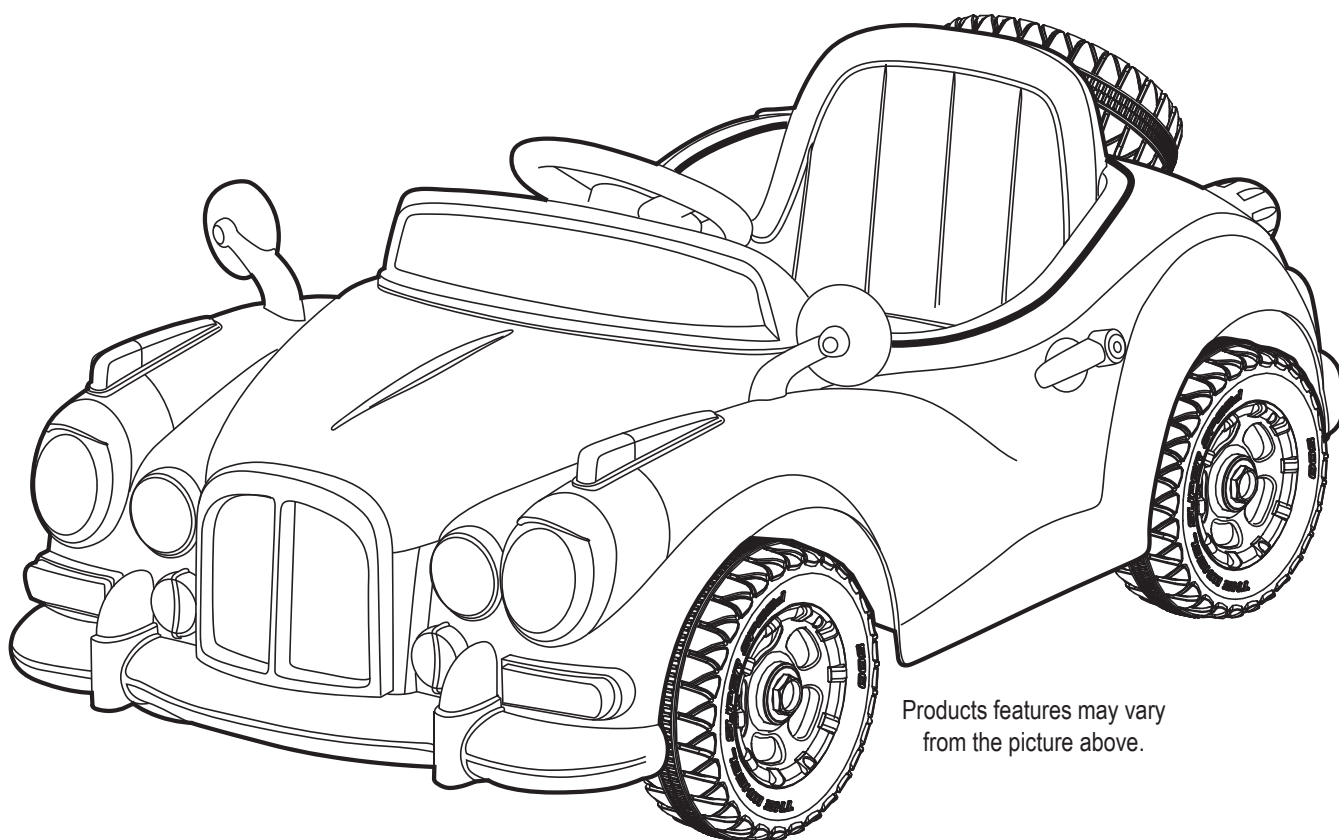

Products features may vary  
from the picture above.

- Suitable for 37~96 Months
- Maximum user weight: 30kg
- Adult assembly required

## **OWNER'S MANUAL with Assembly Instructions**

**Read and understand this entire manual before using!**

Please keep this manual for future reference as it contains important information.

Before first time use, charge the battery for at least 4-6 hours.

## CAUTION



### WARNING

**CHOKING HAZARD** - Small parts.  
Not suitable for children under 36 months.



Use the vehicle on generally level ground ONLY!



### IMPORTANT

**1WD**

This label means the information or assembly for *One Wheel Drive* version ONLY!

**2WD**

This label means the information or assembly for *Two Wheels Drive* version ONLY!

**H/L SPEED**

This label means the information for *High/Low Speed* version ONLY!



## WARNING!

**FOR THE SAFETY OF YOUR CHILD, PLEASE READ ALL WARNINGS AND ASSEMBLY/USE INSTRUCTIONS. KEEP THIS GUIDE FOR FUTURE REFERENCE.**

- **ADULT ASSEMBLY REQUIRED.** The product contains small parts, which are for adult assembly only. Keep children away when assembling.
- Always remove protective material and poly bags and dispose before assembly.

## ABOUT YOUR NEW VEHICLE

Thank you for your purchasing our products, we wants your child to enjoy this product for years to come. Keep these points in mind as you read this guide:

<b>Battery &amp; Fuse:</b>	<b>1WD</b> 6V7AH x1(Fuse: 10A), 6V10AH x1 (Fuse:10A)		
	<b>2WD</b> 6V7AH x2 (Fuse: 5A and 13A), 12V7AH x1 (Fuse: 5A and 13A)		
<b>Load Capacity:</b>	Under 30KGS	<b>Size of car:</b>	125 x 70 x 52 CM
<b>Suitable age:</b>	96 months	<b>Speed:</b>	<b>1WD</b> 3KM/H <b>2WD</b> 3~5KM/H
<b>Average battery life:</b>	Approximately 300 times	<b>Charger:</b>	Input: depend on local voltage Output: DC 6V500mA or DC6V1A or DC12V1A
<b>Charge time:</b>	8-12 Hours	<b>Power way:</b>	Charging type

# PARTS LIST

PART NO.	PART NAME	Q'ty (pcs)	REMARKS
1	Vehicle body	1	
2	Gear box	<b>1WD</b> x1	
		<b>2WD</b> x2	1 pcs labeled "R" , 1 pcs labeled "L"
3	Driving wheel	<b>1WD</b> x1	
		<b>2WD</b> x2	
4	Normal wheel	<b>1WD</b> x3	
		<b>2WD</b> x2	
5	Bushing	<b>1WD</b> x3	2 pcs placed on the front axle, 1 pcs placed on the rear axle.
		<b>2WD</b> x2	Placed on the front axle
6	Motor hood	<b>1WD</b> x1	
		<b>2WD</b> x2	Placed on the steering wheel
7	Ø4x12 flat head screw	<b>1WD</b> x4	
		<b>2WD</b> x8	
8	Ø12 washer	9	
9	Ø10 locknut	4	
10	M5x16 machine screw	2	Placed on the vehicle body
11	Side support	2	
12	Steering column	1	
13	Rear axle	1	
14	Windshield	1	
15	View mirror	2	
16	Steering wheel	1	
17	M5x35 machine screw	1	Placed on the steering wheel
18	Ø5 nut	2	1 pcs placed on the steering wheel, 1 pcs placed on the steering column.
19	Spare wheel	1	
20	Seat	1	
21	Charger	1	
22	M5x20 machine screw	1	
23	R/C driver	1	
24	Remote controller	1	
A	Ø4x12 round head screw	14	
B	Ø4x16 screw	2	
C	Hubcap	5	
D	Split pin	2	1 pcs FOR SPARE
E	Ø10 Washer	2	1 pcs FOR SPARE
F	Spanner	2	

零件包

# PARTS DIAGRAM

## Tools Required

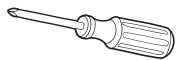

Screwdriver(not included)

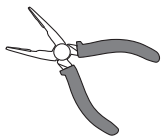

Pliers(not included)

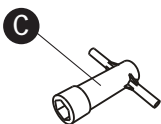

Spanner

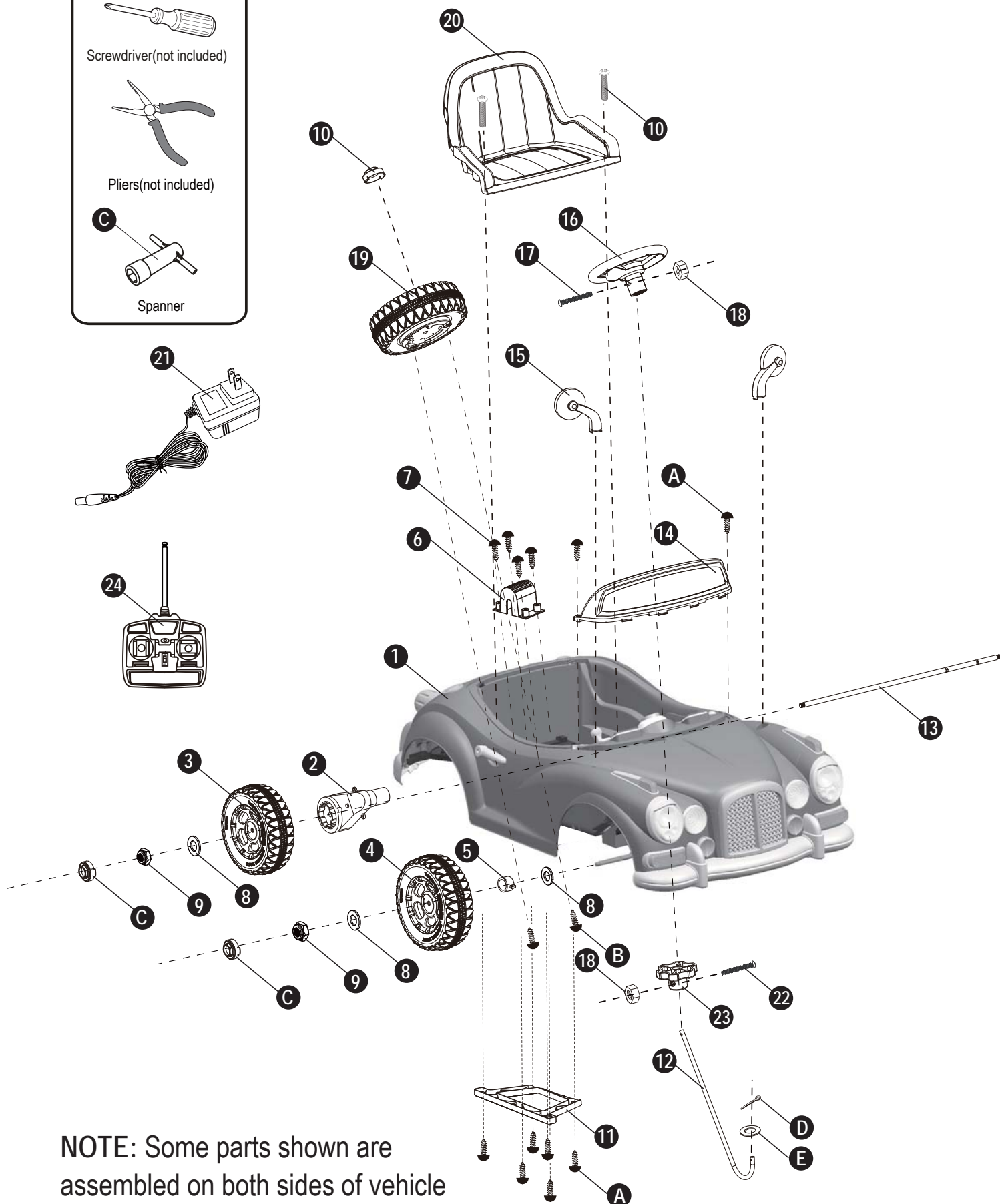

NOTE: Some parts shown are assembled on both sides of vehicle

# ASSEMBLY STEPS

- Your new vehicle requires adult assembly. Please set aside at least 40 minutes for assembly. Children can be harmed by small parts, sharp edges and sharp points in the vehicle's unassembled state. Care should be taken in unpacking and assembly of the vehicle. Children should not handle parts, or help in assembly of the vehicle.
- Please identify all parts before assembly and save all packaging material until assembly is complete to ensure that no parts are discarded.
- Assembly tool for need: screwdriver (provide for oneself) and spanner.

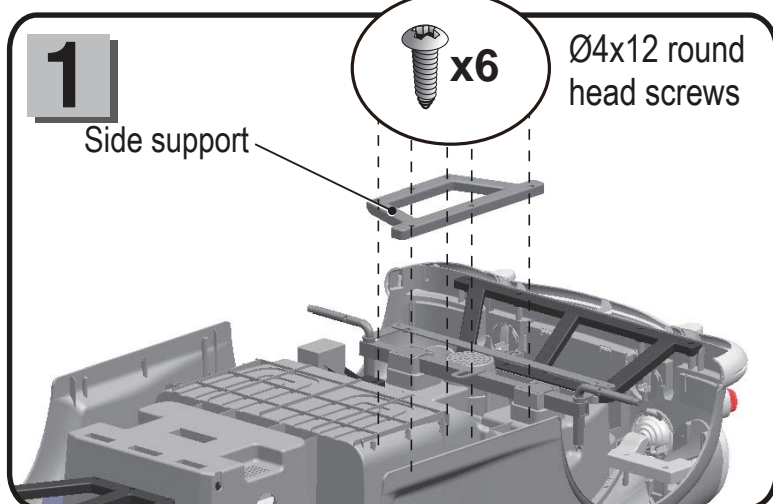

- Turn the vehicle body downside up.
- Fit the side support to the vehicle body.

(HINT: If the side support does not seem to fit, change the other one and try again! )

- Insert six Ø4x12 round head screws and tighten with a screwdriver.
- Repeat for the other side.

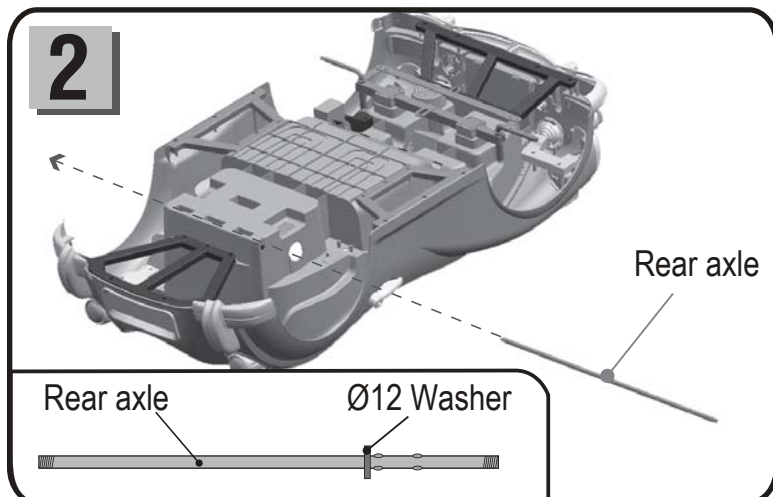

- Remove all the parts from the rear axle. **1WD**
- Slide a Ø12 washer onto the rear axle from the longer end.
- Insert the rear axle through the hole in vehicle body.

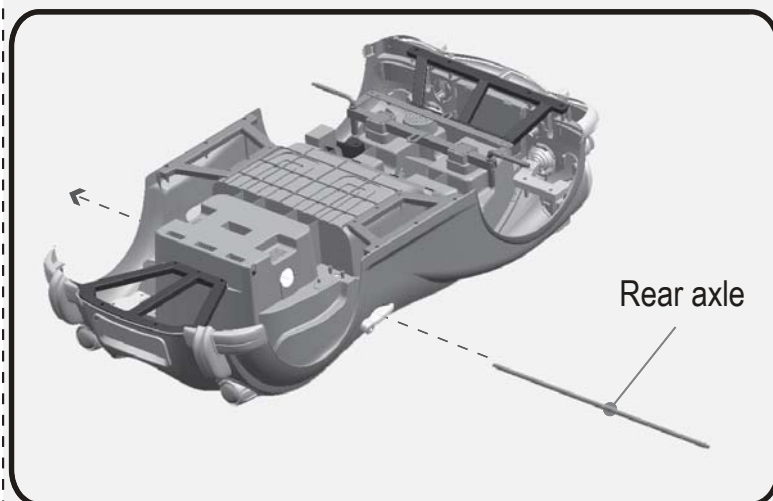

- Remove all the parts from the rear axle.
- Insert the rear axle through the hole in the vehicle body.

**2WD**

# ASSEMBLY STEPS



Driving wheel



Spare wheel



Normal wheel

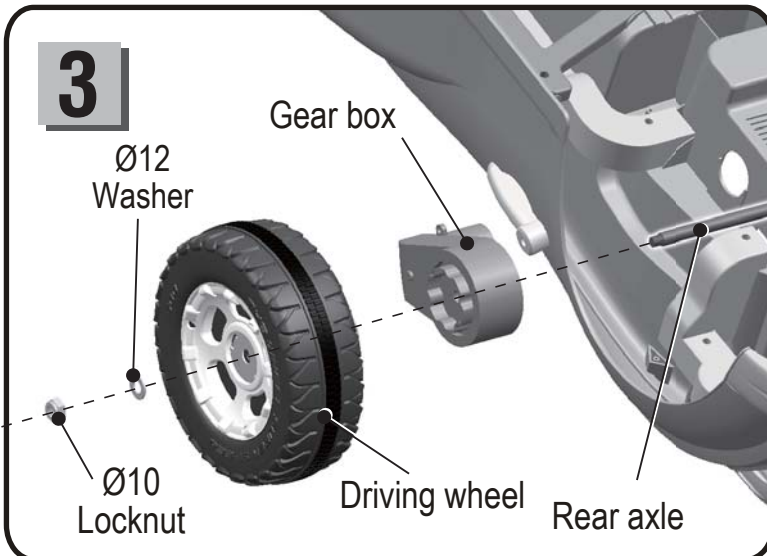

- Fit the gear box onto the rear axle from the left side (Standing at the rear of the vehicle body). And make the motor on the gear box pass through the hole in the vehicle body. **1WD**
- Fit the driving wheel onto the rear axle, keep it match with the gear box.
- Fit a Ø12 washer onto the rear axle.
- Fit a Ø10 locknut to the end of the rear axle.

- Slide the gear box (standing at back of vehicle body) onto the rear axle. "R" labeled gear box should be fit to the "R" side of vehicle body; "L" labeled gear box should be fit to "L" side of vehicle body.
- Slide the driving wheel onto rear axle, make it match with the gear box.
- Slide a Ø12 washer.
- Tighten the Ø10 locknut with a spanner. (Do not over tighten)
- Repeat this procedure to assemble the other driving wheel to the rear axle. **2WD**

**Hint: An extra spanner has been provided to hold the Ø10 locknut on the other side of the front axle while tightening the locknut on the other side.**

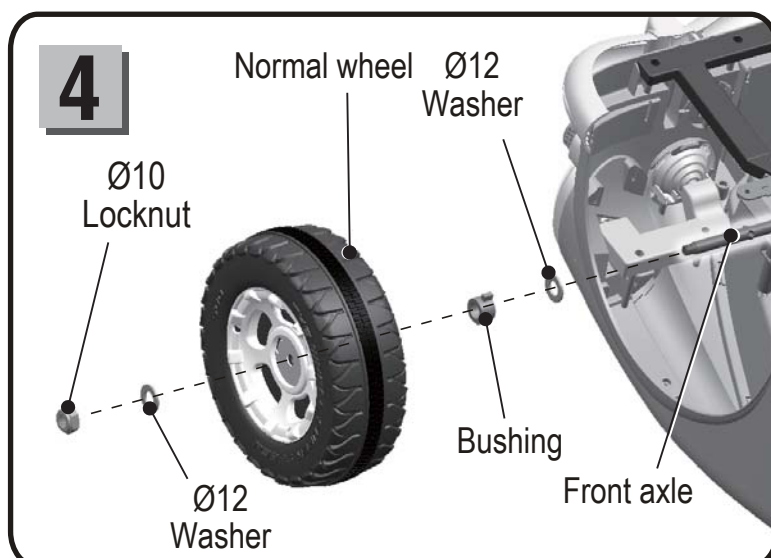

- Remove the parts from the front axle.
- Fit a Ø12 washer onto the axle.
- Fit a bushing onto the axle.
- Fit a normal wheel onto the axle, make the wheel match with the bushing.
- Fit a Ø12 washer onto the axle.
- Tighten the Ø10 locknut with a spanner. (Do not over tighten)
- Repeat for the other wheel(s).

# ASSEMBLY STEPS

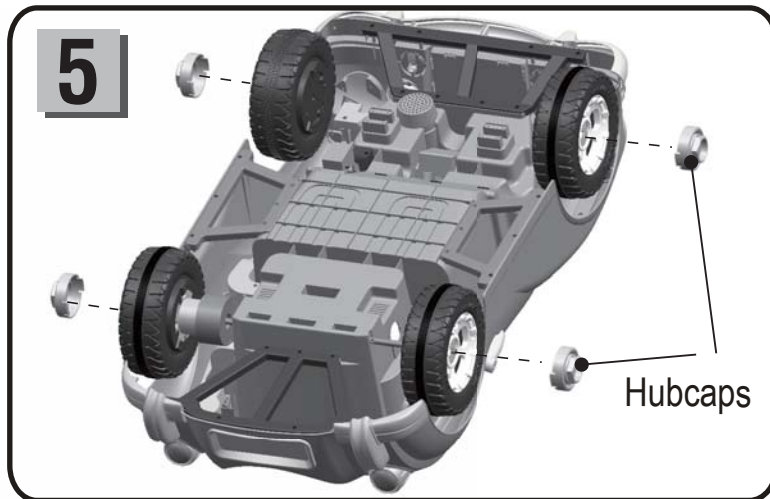

- “Snap” a hubcap onto the center of each wheel cover.

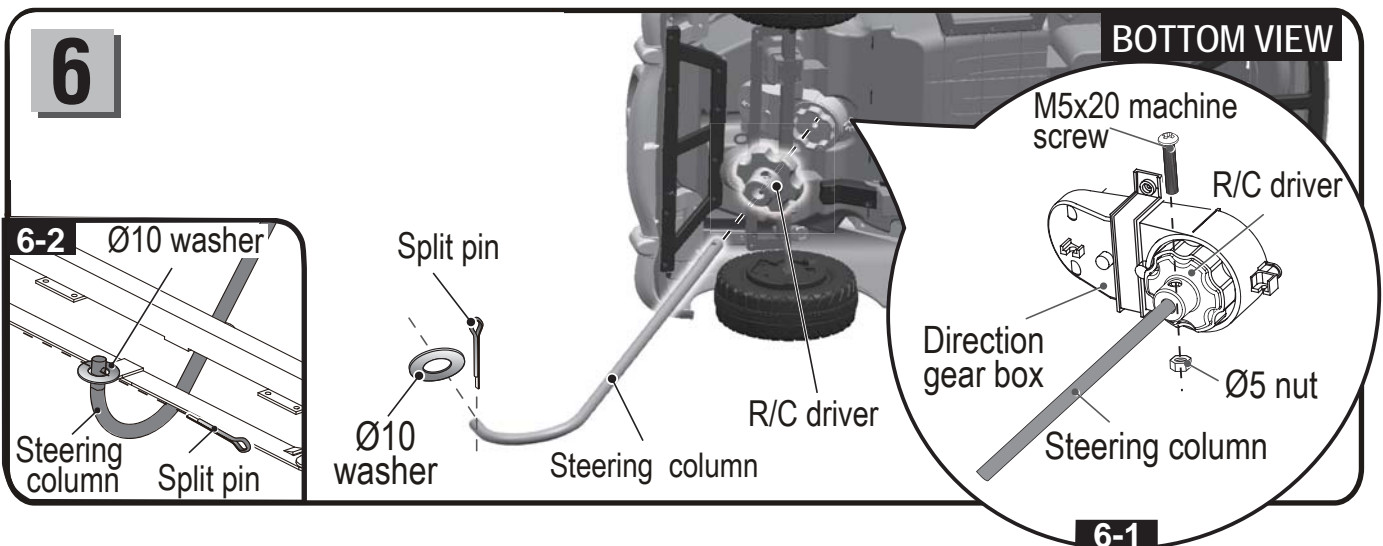

- Turn the vehicle body on its side.
- Remove the screw and nut from the R/C driver with a screwdriver.
- Insert the straight end of steering column up through the hole in the R/C driver, the hole in the direction gear box and the hole in the vehicle body. Continue pushing the steering column to pass through the hole in the dash.
- Line up the holes in the R/C driver with the hole in the steering column, tighten the M5x20 machine screw and Ø5 nut back in the same location with a screwdriver(PIC 6-1).
- Insert the bent end of steering column through the hole in the front axle linkage, insert a Ø10 washer onto the steering column and insert a split pin into the hole in the steering shaft, bend the ends of split pin back using a pair of pliers(PIC 6-2).

# ASSEMBLY STEPS

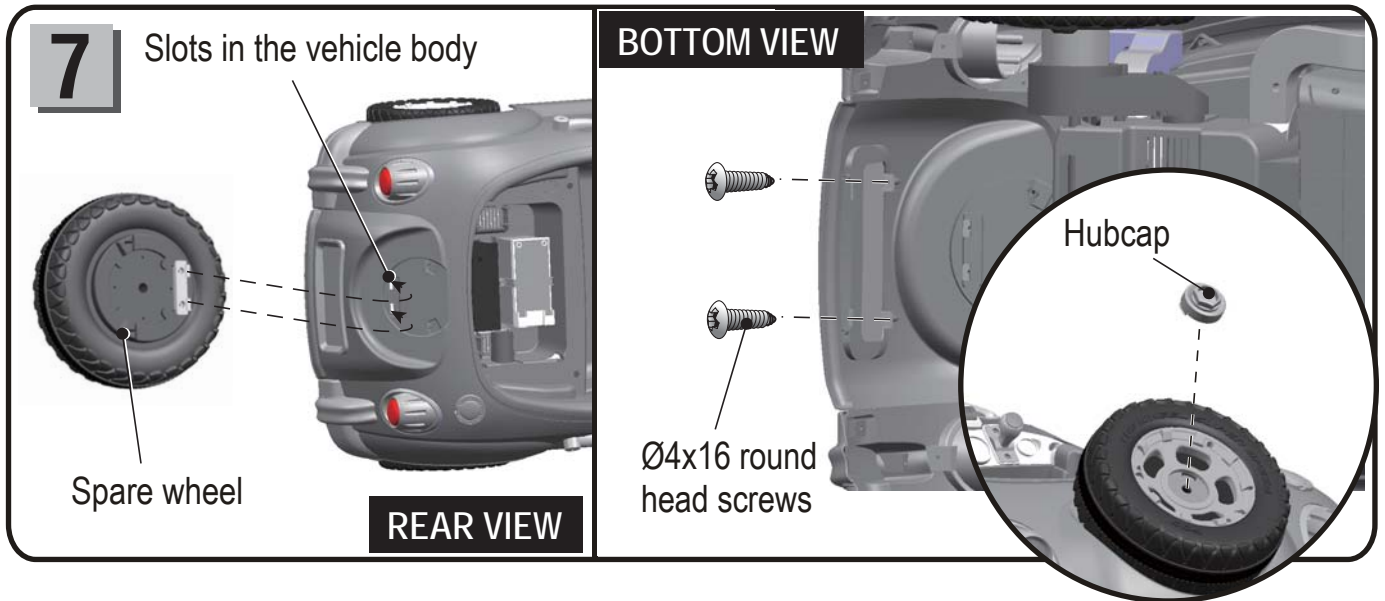

- Insert the tabs in the spare wheel into the slots at the rear of the vehicle body,
- Insert two Ø4x16 round head screws through the vehicle body wall and into the spare wheel, tighten with a screwdriver.
- “Snap” the hubcap into the wheel cover of spare wheel.

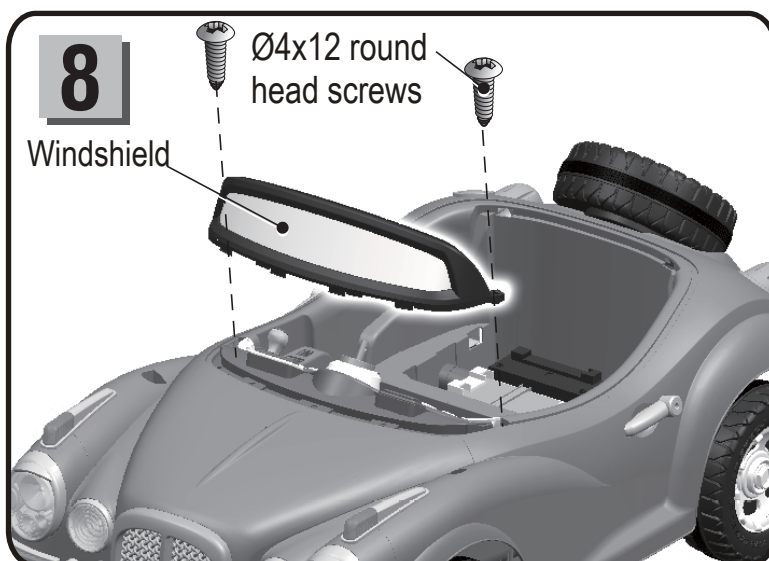

- Turn the vehicle body upright.
- Fit the tabs on the windshield into the slots in the vehicle.
- Insert two Ø4x12 round head screws and tighten with a screwdriver.

# ASSEMBLY STEPS

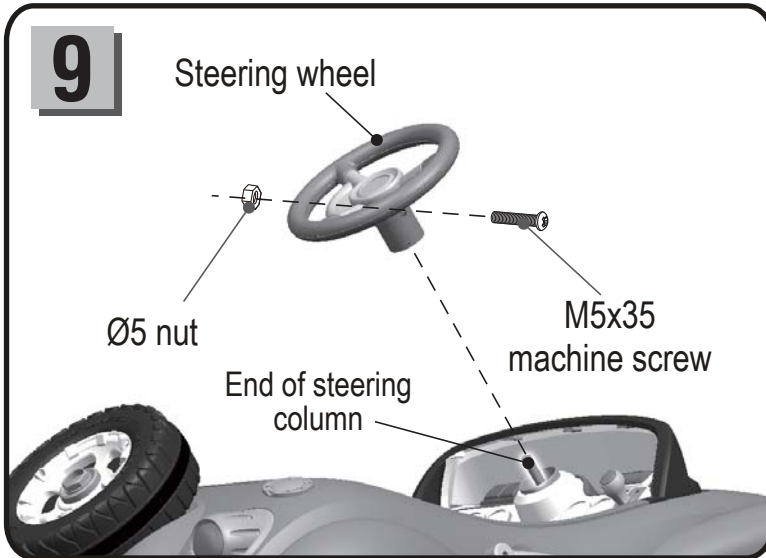

- Remove the M5x35 machine screw and Ø5 nut from the steering wheel.
- Insert the steering wheel to the end of the steering column.
- Insert the M5x35 machine screw through the steering wheel and steering column, and tighten the Ø5 nut back in the same location.

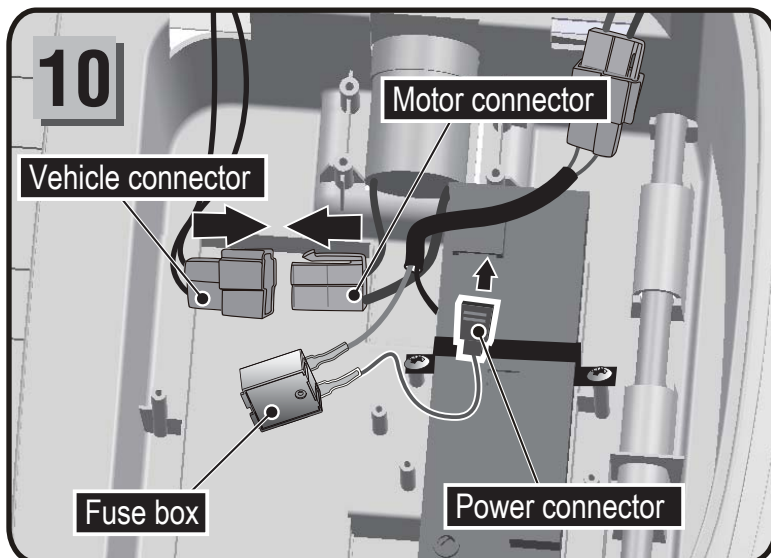

- Plug the power connector into the terminal on battery as shown.
- Plug the vehicle connector(s) into the motor connector(s).

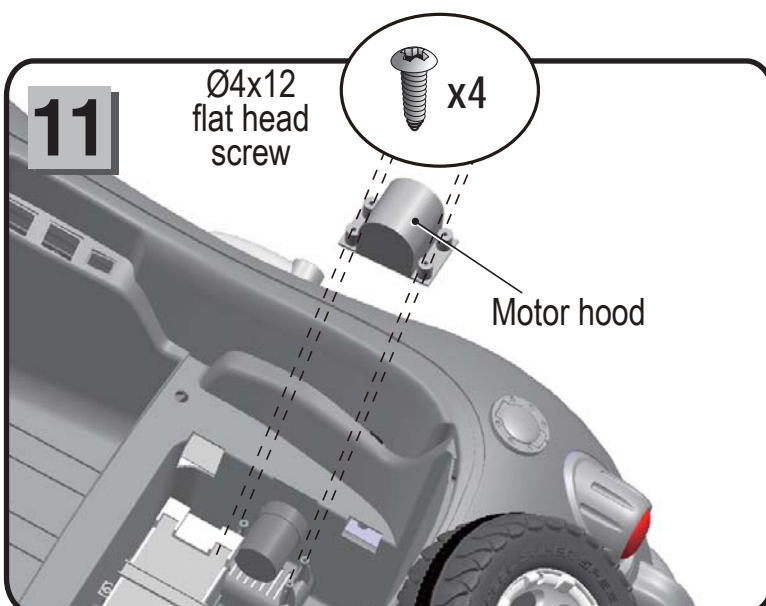

- Fit the motor hood on the motor. **1WD**
- Tighten four Ø4x12 flat head screws to secure it.

- Repeat for the other side.

**2WD**

# ASSEMBLY STEPS

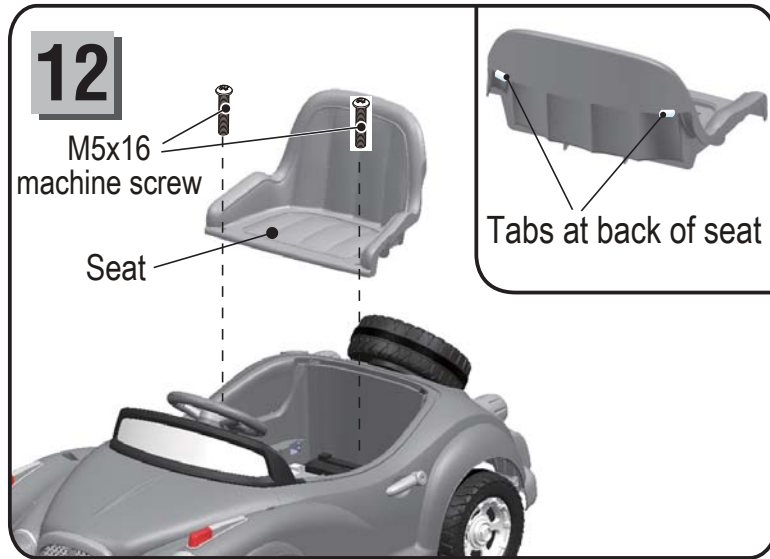

- Insert the tabs at the back of the seat into the slots in the vehicle body.
- Insert two M5x16 machine screws, and tighten with a screwdriver.

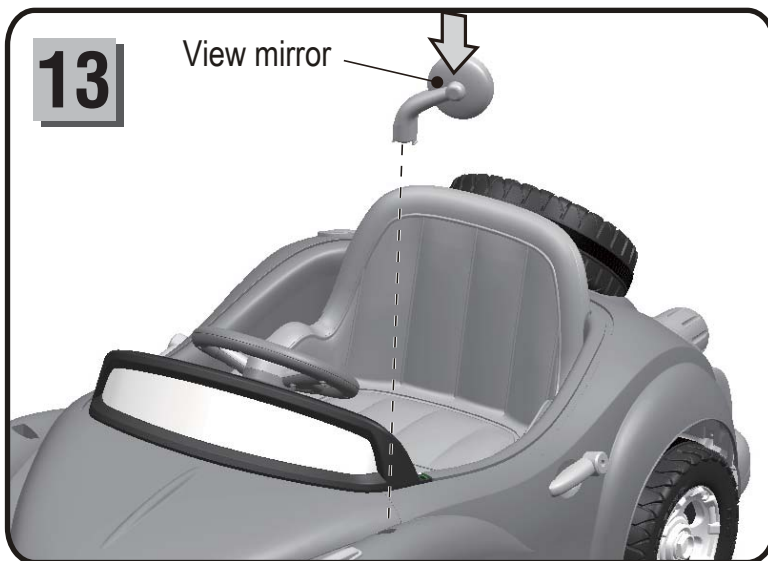

- Insert the view mirror into the hole in the vehicle body and push until you hear this click into place.
- Repeat for the other side.

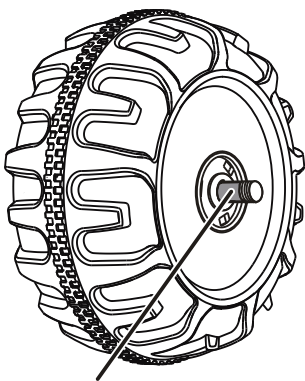

**GAP**

## IMPORTANT SUPPLEMENT TO INSTRUCTION MANUAL

After assembling any wheel to the axles, please check the gap between the screw thread and the collapsible (refer to below picture), if the gap is too big, please add two or three washers inside the wheel, But after tightening the nut outside the wheel, please turn the wheel by your finger to check if the wheel can run smoothly, this is very important, because if the wheel can run smoothly, it is ok, but if the nut press the wheel and the wheel can't run smoothly, the motor will be broken easily! Then you need to decrease one or two washers to make sure the wheel can run smoothly!

# HOW TO OPERATE YOUR VEHICLE

## **WARNING!**

### **PREVENT INJURIES AND DEATHS:**

#### **• NEVER LEAVE CHILD UNATTENDED. DIRECT ADULT SUPERVISION IS REQUIRED.**

Always keep child in view when child is in vehicle.

- This toy should be used with caution since skill is required to avoid falls or collisions causing injury to the user or third parties.
- Protective equipment should be worn.
- Never use in roadways, near cars, on or near steep inclines or steps, swimming pools or other bodies of water.
- Always wear shoes.
- Always sit on the seat.
- Not to be used in traffic.
- This toy is unsuitable for children under 37 months due to its maximum speed; Maximum user weight is 30 kgs.
- This toy has no brake.

### **Must confirm before using that following work which is already finished:**

- Important! Before using the vehicle for the first time, the battery needs to be charged for 4 to 6 hours, no more than 10 hours. Only an adult can charge and recharge the battery.
- Check all the screws, cap nuts and protective coverings regularly and tighten as required. Check plastic parts on a regular basis for cracks or broken pieces.

## **Rules for Safe Riding**

**READ THESE RULES ALOUD TO YOUR CHILD AND THEIR PLAYMATES AND MAKE SURE THEY UNDERSTAND THEM!**

- Keep Children within Safe Riding Areas:
  - Never use in roadway, near motor vehicles, on lawn space, on or near steep inclines or steps, swimming pools or other bodies of water;
- Use the toy only on flat surfaces. Such as inside your house, garden or playground.
- Never use in the dark. A child could encounter unexpected obstacles and have an accident. Operate the vehicle only in the daytime or a well-lit area.
- It is not recommended to drive the vehicle on wet surfaces or on lopes of greater than 15 degrees.
- Do not use this vehicle outdoors when it is raining or snowing.
- Make sure you come to a complete stop before changing directions from forward to back.
- Please follow the correct weight and age limits allowed to drive this vehicle.
- It is prohibited to change the circuit or add other electric parts
- Inspect wires and connections of the vehicle periodically.
- In order to avoid accidents, please ensure the vehicle is safe before riding.
- Do not let any child touch the wheels or be near them when the car is moving .
- This vehicle has adjustable play seat belts. Please instruct children how to tie the safety belt before using, guarantee the security.

# HOW TO OPERATE YOUR VEHICLE

## Use Operation A

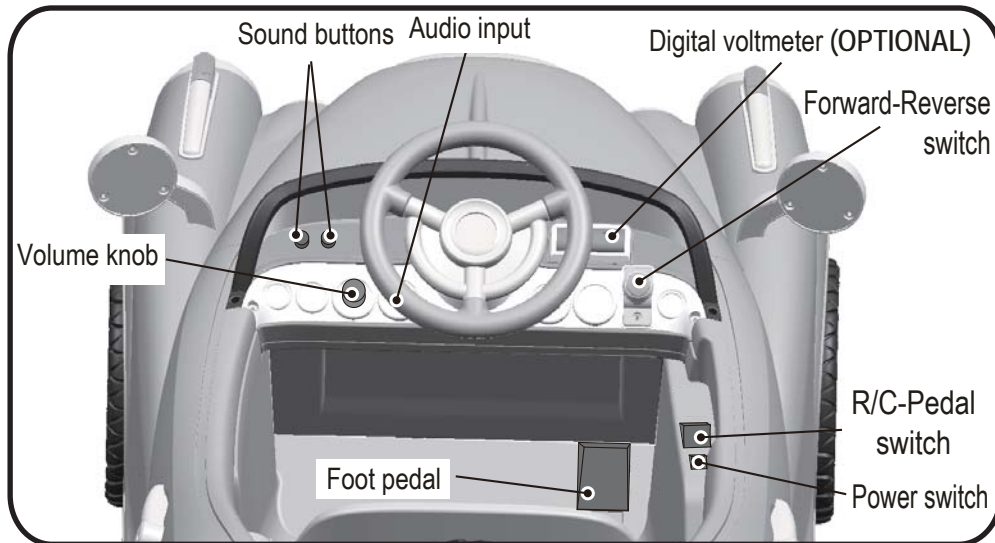

### IMPORTANT!

Always stop vehicle when changing the speed or direction to avoid damage the gears and motor.

## H/L SPEED Use Operation B

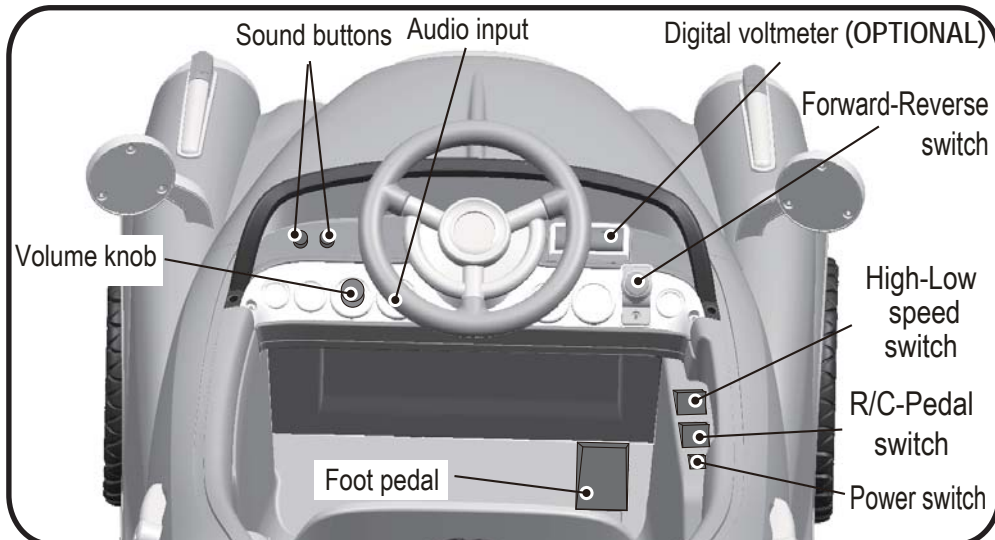

### ADVANCED USE - High speed Drive

Make sure your child knows how to steer, how to start and stop the vehicle and knows the rules for safe driving. The vehicle can be driven at a maximum of 3~5 km/h.

### FORWARD

1. Press the "Forward-backward switch" on the "Forward" position.
2. Press the "Foot pedal", the vehicle drives forward.

### STOP

The vehicle will stop automatically, when your child's foot remove from the "Foot pedal".

### REVERSE

1. Press the "Forward-backward switch" on the "Backward" position.
2. Press the "Foot pedal", the vehicle drives backward.

### SOUNDS BUTTON

Press the buttons on the dash and rear light bar for sound playing.

### VOLUME KNOB

Turn the knob clockwise to increase the volume; Turn the knob counterclockwise to decrease the volume.

### HIGH/LOW SPEED SWITCH (OPTIONAL)

The switch operates the vehicle to move in low or high speed.

### DIGITAL VOLTMETER (OPTIONAL)

See page 14.

# HOW TO USE THE REMOTE CONTROLLER

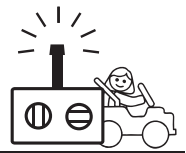

ADULT OPERATING REQUIRED

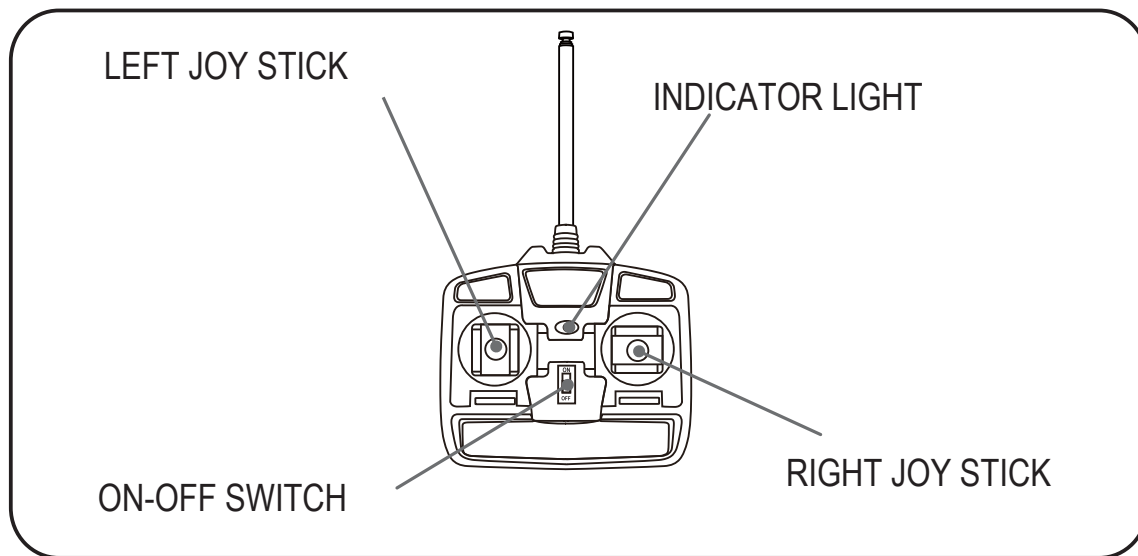

## ASSEMBLY

1. Insert the antenna into the controller by tweak the antenna clockwise;
2. Lift the battery compartment door on the back of the controller and insert two AA(LR6) batteries.

NOTE: This product didn't included the AA(LR6) batteries.

## BATTERY INFORMATION

Batteries may leak fluids that can cause chemical burn injury or ruin your product. To avoid battery leakage:

- Do not mix old and new batteries.
- Do not mix different types of batteries: alkaline, standard (carbon-zinc) or rechargeable (nickel-cadmium). Insert batteries as indicated inside the battery compartment.
- Remove batteries during long periods of non-use. Always remove exhausted batteries from the product. Battery leakage and corrosion can damage this product. Dispose of batteries safely.
- Do not dispose of batteries in a fire. The batteries may explode or leak.
- Never short circuit the battery terminals.
- Non-rechargeable batteries are not to be recharged.
- Use only batteries of the same or equivalent type as recommended.
- If removable rechargeable batteries are used, they are only to be charged under adult supervision.
- Remove rechargeable batteries from the product before charging.
- Batter chargers used with toys must be examined regularly for damage to the cord, plug, enclosure and other parts. In the event that such damage is found, the toy must not be used with the battery charger until the damage has been repaired.

## OPERATION

1. Press the CONVERSION SWITCH on the vehicle to the "Remote control" position.
2. Press the ON-OFF SWITCH on the remote controller to the "ON" position, the indicator light will be lighting.
3. Push the LEFT JOY STICK to the front, the vehicle goes forward, pull the LEFT JOY STICK to the back, the vehicle goes backward.
4. Push the RIGHT JOY STICK to the left, the vehicle turn left, push the RIGHT JOY STICK to the right, the vehicle turns right.

# CHARGING YOUR VEHICLE

**ONLY AN ADULT CAN CHARGE AND RECHARGE THE BATTERY!**

## **WARNING!**

### • **PREVENT FIRE AND ELECTRIC SHOCK:**

- Use the only rechargeable battery and charger supplied with your vehicle. NEVER substitute the battery or the charger with another brand. Using another battery or charger may cause a fire or explosion.
- Do not use the battery or charger for any other product. Overheating, fire or explosion could occur.
- NEVER modify the electric circuit system. Tampering with the electric system may cause a shock, fire or explosion or may permanently damage the system.
- Do not allow direct contact between battery terminals. Fire or explosion can occur.
- Do not allow any type of liquid on the battery or its components.
- Explosive gasses are created during charging. Do not charge near heat or flammable materials. Charge the battery in a well-ventilated area ONLY.
- NEVER pick up the battery by the wires or charger. Damage can occur to the battery and may cause a fire. Pick up the battery by the case ONLY.
- Charge the battery in a dry area ONLY.
- Battery posts, terminals and related accessories contain lead and lead compounds, chemicals known to the State of California to cause cancer and reproductive harm. **Wash hands after handling.**
- Do not open the battery. Battery contains lead acid and other materials that are toxic and corrosive.
- Do not open the charger. Exposed wiring and circuitry inside case may cause electric shock. • Only adults may handle or charge the battery. NEVER allow child to handle or charge the battery. Battery is heavy and contains lead acid (electrolyte).
- Do not drop the battery. Permanent damage to the battery could occur or cause serious injury.
- Before charging the battery, check for wear or damage to the battery, charger, its supply cord and the connectors. DO NOT charge the battery if any damage to parts has occurred.
- Do not allow the battery to drain completely. Recharge the battery after each use or once a month if not used regularly.
- Do not charge battery upside down.
- Always secure the battery with the bracket. Battery can fall out and injure a child if vehicle tips over.

- The charging input socket is at the right side of the spare wheel.
- The POWER SWITCH must be turned in OFF position when charging.
- Before the first use, you should charge the battery for 4-6 hours. Do not recharge the battery for more than 10 hours to avoid overheating the charger.
- When the vehicle begins to run slowly, recharge the battery.
- After each use or once a month minimum recharge time as 8 to 12 hours, less than 20 hours at most.

# CHARGING YOUR VEHICLE

- According the table to decide whether to charge the battery:

BATTERY	MAGNITUDE OF VOLTAGE	BATTERY STATE
6V4Ahx1, 6V7Ahx1 6V10Ahx1	$\geq 6.6$	The battery is full.
	6.5~6.3	The vehicle can wrok normally.
	$\leq 6.2$	STOP operating the vehicle, the battery needs to charge
6V7Ahx2, 6V10Ahx2 12V7Ahx1, 12V10Ahx1	$\geq 13.2$	The battery is full.
	13.1~12.6	The vehicle can wrok normally.
	$\leq 12.5$	STOP operating the vehicle, the battery needs to charge

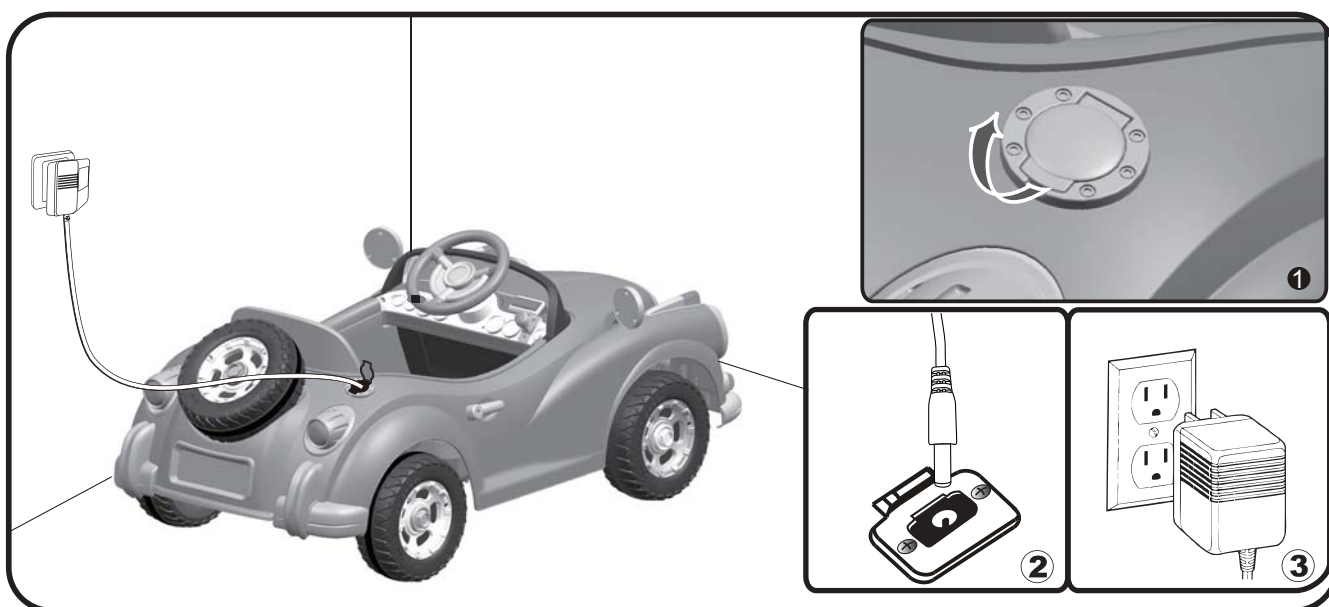

1. Open the cover of the socket (the socket is at the right side of the spare wheel)
2. Plug the charger port into the input socket.
3. Plug the charger plug into a wall outlet. The battery will begin charging.

## **WARNING!**

This product with CHARGING PROTECTION: When charging, all the functions will be cut off!

# TROUBLESHOOTING GUIDE

---

## ■ PROBLEM: The vehicle does not run

### PROBLEM CAUSE: The battery may low on power.

After each use, or once a month minimum, charge the battery for a full 10 hours. Do not leave the battery on the charger for more than 20 hours.

### POSSIBLE CAUSE: Thermal fuse has tripped.

The vehicle is equipped with a self-resetting fuse. When the vehicle is overloaded or operated incorrectly; the self-resetting fuse will be cut off for 5-20seconds before becoming operational again. The self-resetting fuse is under the seat (Refer to the picture.)

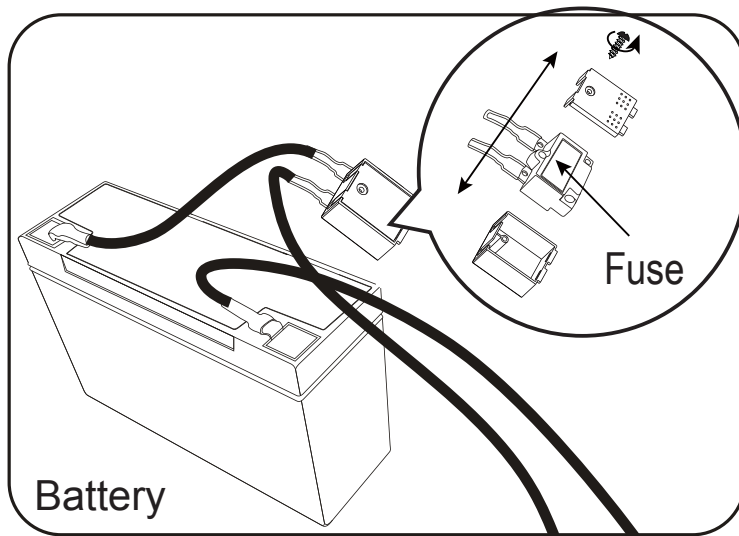

To avoid the fuse cut off the power, follow these guidelines:

DO NOT overload the vehicle, Maximum weight allowed :30kg

DO NOT tow anything behind the vehicle.

DO NOT drive up steep slopes.

DO NOT drive into fixed objects, which may cause the wheels to spin, causing the motor to overheat.

DO NOT drive in very hot weather, components may overheat.

DO NOT tamper with the electric system, Doing so may create a short circuit, causing the fuse to trip.

### POSSIBLE CAUSE: Wheel nuts are loose.

If the nuts are not tight, the wheels will not engage the forward gears. Tighten the nut with the nut wrench.

### POSSIBLE CAUSE: Battery connector or wires are loose.

Make Sure the battery connectors are firmly plugged in to each other.

### POSSIBLE CAUSE: Battery is dead.

Have you properly maintained the battery according to the directions? Is the battery old? Your battery may need to be replaced.

### POSSIBLE CAUSE: Electric system is damaged.

Water may have corroded the system, or loose dirt, gravel or sand might have jammed the switch.

### POSSIBLE CAUSE: Motor is damaged.

The motor needs professional repair.

## ■ PROBLEM: The battery will not recharge.

### POSSIBLE CAUSE: Battery connector or adapter connector is loose.

Make sure the battery connector and adapter connector are firmly plugged together.

### POSSIBLE CAUSE: Charger is not plugged in.

Make sure the charger is plugged into the wall outlet and the power flow to the outlet is on.

### POSSIBLE CAUSE: Charger is not working.

Is the charger warm while charging? If not, the charger may be broken and may need to be replaced.

# TROUBLESHOOTING GUIDE

---

## ■ PROBLEM: The vehicle does not run very long.

### POSSIBLE CAUSE: Battery may be undercharged.

You may not be charging the battery long enough. After each use, or once a month minimum, charge the battery for 8 to 10 hours. Do not leave the battery on the charger for more than 20 hours.

### POSSIBLE CAUSE: Battery is old.

The battery will eventually lose the ability to hold a charge. Depending on the amount of use, and varying conditions, the battery should operate for one to three years. Replace the battery with a new one.

## ■ PROBLEM: Battery buzzes or gurgles when charging.

This is normal and not a cause for concern. It may also be silent when charging, which is also normal.

## ■ PROBLEM: Charger feels warm when recharging battery.

This is normal and not a cause for concern.

# MAINTAINING YOUR VEHICLE

---

- It is parents' responsibility to check main parts of the toy before using. Must regularly examine for potential hazard, such as the battery, charge, cable or cord, plug, screws are fastening enclosure of other parts and that in the event of such damage, the toy must not be until that damage had been properly removed.
- Make sure the plastic parts of the vehicle are not cracked or broken.
- Occasionally use a lightweight oil to lubricate moving parts such as wheels.
- Park the vehicle indoors or cover it with a tarp to protect it from wet weather.
- Keep the vehicle away from sources of heat, such as stoves and heaters. Plastic parts may melt.
- Recharge the battery after each use. Only an adult can handle the battery. Recharge the battery at least once a month when the vehicle Raider is not being used.
- Do not wash the vehicle with a hose. Do not wash the vehicle with soap and water. Do not drive the vehicle in rainy or snowy weather. Water will damage the motor, electric system and battery.
- Clean the vehicle with a soft, dry cloth. To restore shine to plastic parts, use a non-wax furniture polish. Do not use car wax. Do not use abrasive cleaners.
- Do not drive the vehicle in loose dirt, sand or fine gravel which could damage moving parts, motors or the electric system.
- When not using, all the electrical source should be turn off. Turn off the power switch and disconnect the battery connection.

# DISPOSAL OF BATTERY

---

## Disposal Of Battery



- Your sealed lead-acid battery must be recycled or disposed of in an environmentally sound manner.
- Do not dispose of your lead-acid battery in a fire. The battery may explode or leak.
- Do not dispose of a lead-acid battery in your regular, household trash. The incineration, land filling or mixing of sealed lead-acid batteries with household trash is prohibited by law.
- Return an exhausted battery to your local approved lead-acid battery recycle, such as a local seller of automotive batteries.
- Contact your local waste management officials for other information regarding the environmentally sound recycling and disposal of lead-acid batteries.

Our products are suitable for  
ASTM F963; GB6675; EN71 and EN62115 standard.