

# CHILDREN'S ELECTRONIC TOY CAR OPERATION INSTRUCTIONS

**Please read this manual in detail before using**



Please read the assembly manual carefully before operating.

**Suitable for ages 3-7 years**

**Always wear helmet when riding**

Your new vehicle requires to be assembled by adult only.  
Please keep this manual since it contains important information.  
Before first time use, charge the battery at least 10 hours.



## WARNING

**ASSEMBLY SHOULD BE DONE BY ADULT**

1. PRODUCT SPECIFICATION
2. PARTS LIST
3. CAUTIONS FOR SAFETY
4. PARTS DIAGRAM
5. ASSEMBLY STEPS
6. VEHICLE FUNCTION
7. CHARGING THE VEHICLE
8. FUSE
9. TROUBLE SHOOTING GUIDE
10. MAINTAINING YOUR VEHICLE
11. DISPOSAL OF BATTERY

### 1. Product Specification

Suitable age:	3-7Years	Battery:	6V 7-10AH*1/7AH*2
Load Capacity:	25kg	Size of car:	115*76*75CM
Speed:	3~5km/h	Power way:	Charging type
Charge:	Input: depend on local voltage Output: DC 6V1000mA	Average battery life:	Approximately 300 times
Charge time:	8-12 Hours	Fuse	10A / 20A

### 2. Parts list



Vehicle Body x1



Sitx1



Dash board X1



Direction Rod X1



Rear axle X1

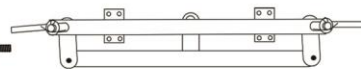

Front axle X1



Wheel x4



6 Volt Charger x1



Escape-pipe x1



Steering Wheel x1



Wheel spad x4

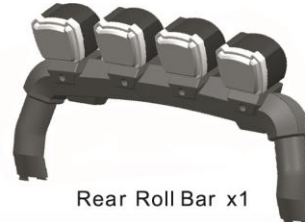

Rear Roll Bar x1



Tail Pipe x2

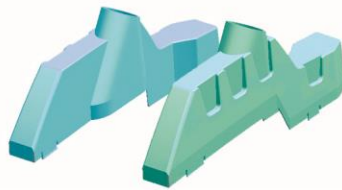

Rear Armrest x2

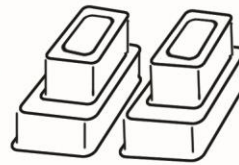

Front Axle holder x2



Rear wheel connection x1/2

Screw Packing



Ø11washer x8



Ø4x16 machina screw x8



Locknut x5



Axle x8



Wheel trim x4



Ø4x12 machina screw x34



M5X30 screw x1



Ø16X80 Iron tube x1

### 3. CAUTIONS FOR SAFETY

1. While riding, adult supervision is required at all times.  
Always wear a helmet when riding.
2. Do not drive near roads or on the footpath.
3. It is not recommended to drive the vehicle on wet surfaces or on slopes of greater than 15 degrees.

4. It is not recommended to ride this vehicle on sandy or soft surfaces.
5. Do not use this vehicle outdoors when it is raining .
6. Make sure you come to a complete stop before changing directions from forward to back.
7. Don't allow children to operate the charger or play with the battery.
8. Clean the motorcycle with a dry cloth only.
9. Please follow the correct weight and age limits allowed to drive this vehicle.
10. It is prohibited to change the circuit or add other electric parts.
11. Adults must teach their children about safe driving procedures.
12. Please cut off the power when stop driving.
13. Check the seat whether it has been fitted and secured with a bolt before driving.
14. Inspect wires and connections of the vehicle periodically
15. Don't mix new and old batteries.
16. Charging the battery should only be done by adults.  
Charging plug is located underneath the seat.
17. In order to avoid accidents ,please ensure the vehicle is safe before riding.
18. Check all wire plugs and connections periodically.

## Parts Diagram

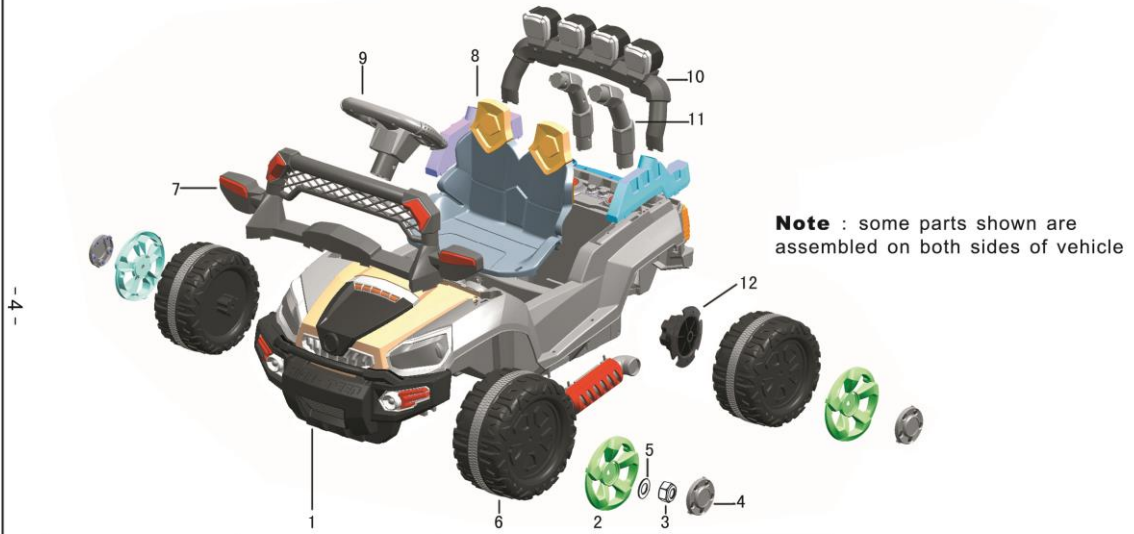

① Vehicle Body x1	② Wheel spad x4	③ Locknut X4	④ Wheel trim x4
⑤ Φ10 Washers X 7	⑥ Wheel x4	⑦ Dash board X1	⑧ Backrest X1
⑨ Steering Wheel x1	⑩ Rear Roll Bar x1	⑪ Tail Pipe x2	⑫ Rear wheel connection x1/2

### Tools Required



Screwdriver(not included)



## Assembly Steps

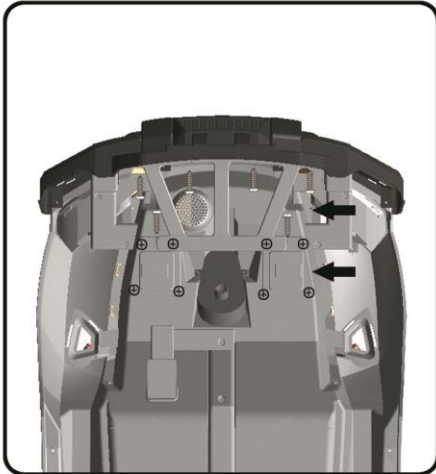

### Assemble front axle holder & front insurance holder

- With 4X16 screws fixed the front axle holder.
- With 6 only 4X12 screws fixed the front insurance holder.

### Assemble axle

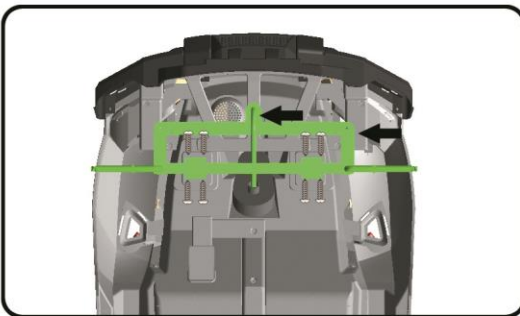
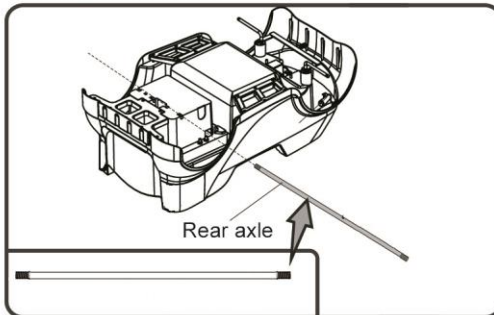

### Assemble Steering Rod & Front Axle

- Insert the steering end of steering shaft up through the hole on the front of vehicle body from bottom side to dash board.
- Insert the bent end of steering shaft through the hole in the front axle plate, use 8pcs 4\*12 machine screw to lock it. Put a gasket the end of steering rod, and then use M10 machine screw to lock it.

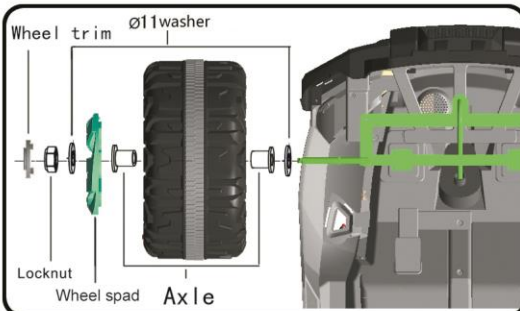

### Assemble wheel

- Screw off the nut from the axle, take the ø11 washer and round bushing out
- Slide the round bushing (ring end first) onto the axle.
- Slide the wheel (ribbed side first) onto the axle. Slide the ø11 washer onto the axle.
- Fasten the locknut by a spanner, lastly insert a decoration cover into the wheel cover. Remember to follow the same steps for the other wheel.

## Assembly Steps

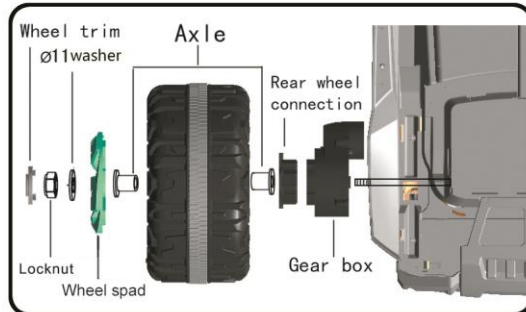

### Assemble real driving wheel

- First the gear case onto the rear axle .
- Connect the cable of the motor and the cable of the car.
- Slide the driving wheel onto the rear axle . make sure the driving wheel inserts onto the pins in the gear case.
- Slide the Ø11 washer onto the rear axle. Fasten locked by a spanner, lastly insert a decoration cover into the wheel cover.

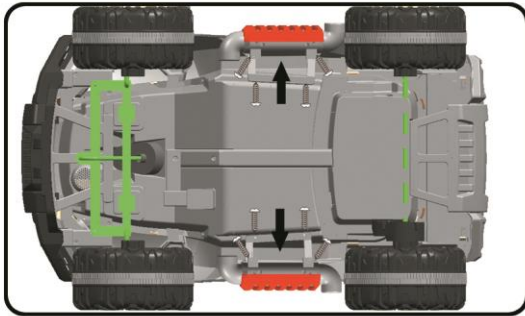

### Assemble Escape-pipe

- Will escape-pipe bracket hole and car body on the corresponding feet fit well. than with 4X12 self-tapping fixed.



### Assemble of steering wheel

- Screw off the nut from the steering wheel. insert the steering wheel onto the end of the steering column. Pay attention to the steering wheel front and back.
- With 4X12 screws 2 to around the escape-pipe which the body in turn.

## Assembly Steps



### Assemble Dash board

- Insert the **dash board** into the holes on vehicle.



### Assemble Rear armrest

- Insert the **rear armrest** into the holes on vehicle.  
The light of the line on the right body through the armrest



### Assemble Rear roll bar

- Insert the holder to alarm lamp, then insert the four feet to carbody. Final, use 2pcs 4\*12 machine screw to lock it.  
**CAUTION!** Before assemble the holder, connect the alarm lamp wire with carbody wire.



## Assembly Steps



### Connecting power supply & Assembling seat

- Cushion before installation, first connect the battery of car body line, At the same time, the line on the gear box and automobile body line connection. Insert the tabs at the back of the seat into the slots in the vehicle body. Insert two M4X12 machine screws, and tighten with a screwdriver.

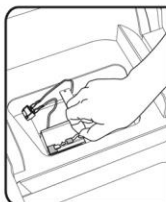

- Plug two connector into each other (red to red , black to black) according to the picture.

## Vehicle Function

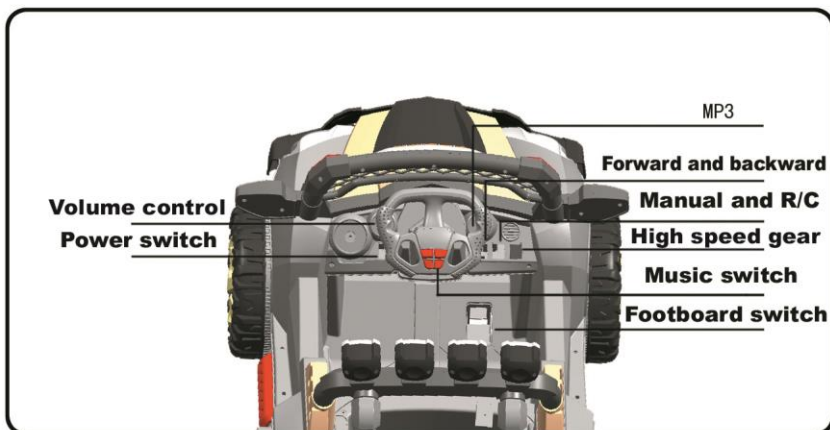

## Charging The Vehicle

Charge socket is at the right

**Caution: You must charge the 6-Volt battery for a “Full” 10 hours prior to use.**

**Never charge the battery longer than 20 hours.**

Failure to charge the battery as directed will cause permanent damage to the battery.

After each use, or once a month minimum, recharge the battery of your vehicle for 8-10 hours. Do not charge the battery longer than 20 hours.

NEVER run battery completely flat.

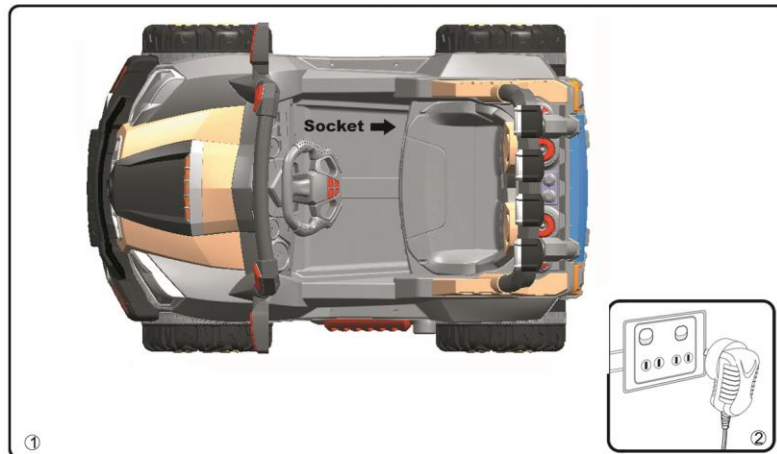

Find the socket As shown ①

Plug the charger port into the input socket.

Plug the charger plug into a wall outlet. As shown ②

## Fuse

When the vehicle won't work or can not be charged, please check the fuse .replace the fuse if necessary, and wait for 15 seconds after the fuse reset and power or restored.

The car features one thermal reset fuse in under the seat. ( Refer to the picture.)

They will automatically trip and cut all power to vehicle if the motor, electric system or battery is overload. The fuse will reset and power will restored, after approximately 15 seconds.

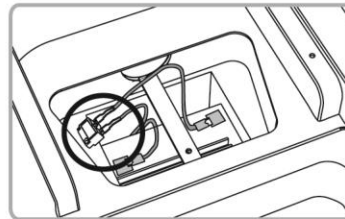

## Trouble Shooting Guide

Problem	Possible Cause
(1).The 6-Volt battery Will not recharge	<ol style="list-style-type: none"> <li>1.Motor connector or adapter connector is loose. Make sure the motor connector and the adapter connector is firmly plugged.</li> <li>2.The 6-volt battery will not recharge. Make sure the charger is plugged into a 240v wall outlet and the power flow to the outlet is on.</li> <li>3.Charger is not plugged in. Make sure the charger is plugged into a 240v wall outlet and the power flow to the outlet is on.</li> <li>4.Check and replace fuse if necessary</li> </ol>
(2).The vehicle does not run	<ol style="list-style-type: none"> <li>1.The battery may be low on power. After each use, or once a month minimum, charge the battery for a "full" 10 hours. DO NOT leave the battery on the charger for more than 20 hours.</li> <li>2.Thermal fuse has tripped. Replace the tripped fuse by another spare one.</li> <li>3.Wheel nuts are loose. If the wheel nuts with a wrench.</li> <li>4.Motor connector or wires are loose. Make sure the motor connector is firmly plugged into the battery.</li> <li>5.Battery is dead. Have you properly maintained the battery according to the directions? Is the battery old? Your battery may need to be replaced.</li> <li>6.Electrical system is damaged. Water may have corroded the system, or loose dirt, gravel or sand might have jammed the switch. Check.</li> <li>7.Motor is damaged. The vehicle needs professional repair.</li> </ol>
(3).The vehicle does not run very long.	<ol style="list-style-type: none"> <li>1.Battery may be undercharged. You may not be charging the battery long enough. After each use, or once a month minimum, charge the battery for a "full" 10 hours. DO NOT leave the battery on the charger for more than 20 hours.</li> <li>2.Battery is old. The 6-volt battery will eventually lose the ability to hold a charge. Depending on the amount of use, and varying conditions, the battery Should operate for one to three years. Replace the battery with a new 6-volt battery.</li> </ol>
(4).Battery buzzes or gurgles when charging.	<ol style="list-style-type: none"> <li>1.This is normal and not a cause for concern. It may also be silent When charging, which is also normal.</li> </ol>
(5).Charger feels warm when recharging battery.	<ol style="list-style-type: none"> <li>1.This is normal and not a cause for concern.</li> </ol>

(6).The vehicle runs sluggishly or beeping occurs.	<ol style="list-style-type: none"> <li>1.Battery needs recharging. After each use, or once a month minimum, charge the battery for a "full" 10 hours. DO NOT leave the battery on the charger for more than 20 hours. Low battery signal will sound when the battery is running low on power.</li> <li>2.Battery is old. The 6-volt battery will eventually lose the ability to hold a charge. Depending on the amount of use, and varying conditions, the battery Should operate for one to three years. Replace the battery with a new 6-volt battery.</li> <li>3.Vehicle is overloaded. Maximum weight is 25 kg. DO NOT overload the vehicle. DO NOT tow anything behind the vehicle. ONLY one rider at a time.</li> </ol>
--	---

## Maintaining Your Vehicle

- Occasionally use a lightweight oil to lubricate moving parts such as wheels and the steering linkages.
- Park the vehicle indoors or cover it with a tarp to protect it from wet weather.
- Keep the vehicle away from sources of heat, such as stoves and heaters. Plastic parts may melt.
- **ADULTS ONLY:** Recharge the battery after each use. Recharge the battery at least once a month when the vehicle is not being used. See page 7 for instructions about recharging the battery.
- **DO NOT** wash the vehicle with a hose. **DO NOT** wash the vehicle with soap and water.
- **DO NOT** drive the vehicle in rainy or snowy weather. Water will damage the motor, electric system and battery.
- Clean the vehicle with a soft, dry cloth. To restore shine to plastic parts, use a non-wax furniture polish. **DO NOT** use car wax. **DO NOT** use abrasive cleaners.
- **DO NOT** drive the vehicle in loose dirt, sand or fine gravel, which could damage moving parts, motors or the electric system.

## Disposal Of Battery

### Disposal of Battery



- Your sealed lead-acid battery must be recycled or disposed of in an environmentally sound manner.
- Do not dispose of your lead-acid battery in a fire. The battery may explode or leak.
- Do not dispose of a lead-acid battery in your regular, household trash. The incineration, land filling or mixing of sealed lead-acid batteries with household trash is prohibited by law.
- Return an exhausted battery to your local approved lead-acid battery recycle, such as a local seller of automotive batteries.
- Contact your local waste management officials for other information regarding the environmentally sound recycling and disposal of lead-acid batteries.