

# Mercedes-Benz X-Class

Ride On Toy



## **WARNING**

Must be assembled by an adult.



- Suitable for 3+ Years
- Maximum user weight: 50kg

# **OWNERS MANUAL**

## **with Assembly Instructions**

**Read and understand this entire manual before using!**

**Please keep this manual for future reference as it contains important information.  
Before first time use, charge the battery for at least 8-12 hours.**

“Mercedes-Benz”,  ,  and the design of the enclosed product are subject to intellectual property protection owned by Daimler AG. They are used by Pinghu City Xiao Ming Xing Children's Products CO.,LTD

## Specification

<b>Suitable age:</b>	3+ Years
<b>Battery:</b>	<b>2WD</b> 12V 7AH x1 <b>4WD</b> 12V 10AH x1
<b>Charge time:</b>	8-12 hours
<b>Charge:</b>	Input: depend on local voltage output: DC12V1000mA
<b>Load capacity:</b>	Under 50 kg
<b>Size of car:</b>	140*76.2*64.3 cm
<b>Speed:</b>	2-8 km/h
<b>Motor:</b>	550-10000



## BATTERY INFORMATION

- Non-rechargeable batteries are not to be recharged.
- If removable rechargeable batteries are used, they are only to be charged under adult supervision.
- Remove rechargeable batteries from the product before charging.
- Do not mix old and new batteries. Do not mix different types of batteries: alkaline, standard (carbon-zinc) or rechargeable (nickel-cadmium).
- Insert batteries as indicated inside the battery compartment, anode to anode, cathode to cathode.
- Remove batteries during long periods of non-use. Always remove exhausted batteries from the product. Battery leakage and corrosion can damage this product. Dispose of batteries safely.
- Never short circuit the battery terminals.

NO.	PART NAME	Q'TY (PCS)		REMARK
		4WD	2WD	
1	Vehicle body	1	1	
2	Gear box	4	2	
3	Driving wheel	4	2	
4	Φ12 washer	6	6	
5	Lock nut	4	4	
6	Wheel cover	4	4	
7	Front wheel	0	2	
8	Seat	1	1	
9	Φ5x12 screw	12	12	
10	Door	2	2	
11	Wing mirror	2	2	
12	Steering wheel	1	1	
13	M5X45 machine screw	1	1	
14	Φ5 nut	1	1	
15	Trailer board	1	1	
16	Rear support	1	1	
17	Roll bar	1	1	
18	Trailer gate	1	1	
19	Spanner	2	2	
20	Charger	1	1	
21	Remote controller	1	1	

• Assembly tools required:

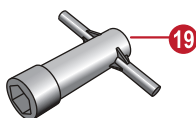

Spanner



Screwdriver (not included)

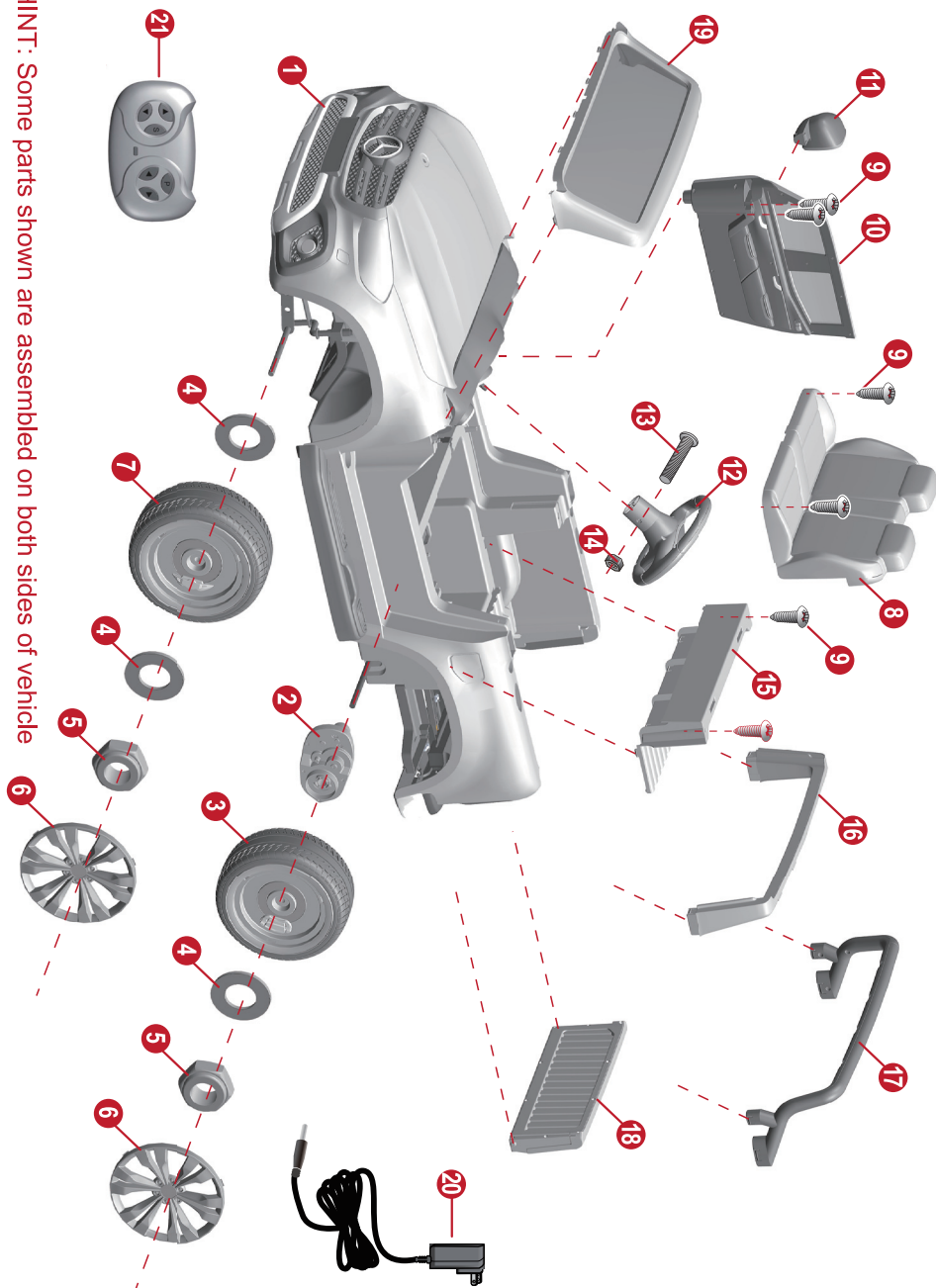

HINT: Some parts shown are assembled on both sides of vehicle

**PREVENT INJURIES AND DEATHS:**

- **NEVER LEAVE CHILD UNATTENDED. ADULT DIRECT SUPERVISION IS REQUIRED.** Always keep child in view when child is in vehicle.
- This toy should be used with caution since skill is required to avoid falls or collisions causing injury to the user or third parties.
- Protective equipment should be worn.
- Never use in roadways, near cars, on or near steep inclines or steps, swimming pools or other bodies of water.
- Always wear shoes, always sit on the seat.
- Not to be used in traffic.
- This toy is unsuitable for children under 36 months due to its maximum speed; Maximum user weight is 50 kg.
- This toy has no brake.

**WARNING:**

- **CHOKING HAZARD!** Not suitable for children under 36 months.
- **ADULT ASSEMBLY REQUIRED.**

**Rules for Safe Riding**

- Keep Children within Safe Riding Areas:
  - Never use in roadway, near motor vehicles, on lawn space, on or near steep inclines or steps, swimming pools or other bodies of water;
- Use the toy only on flat surfaces. Such as inside your house, garden or playground.
- Never use in the dark. A child could encounter unexpected obstacles and have an accident. Operate the vehicle only in the daytime or a well-lit area.
- It is prohibited to change the circuit or add other electric parts
- Inspect wires and connections of the vehicle periodically.
- Do not let any child touch the wheels or be near them when the car is moving .
- This vehicle has adjustable play seat belts. Please instruct children how to tie the safety belt before using, guarantee the security.

Rear bottom view

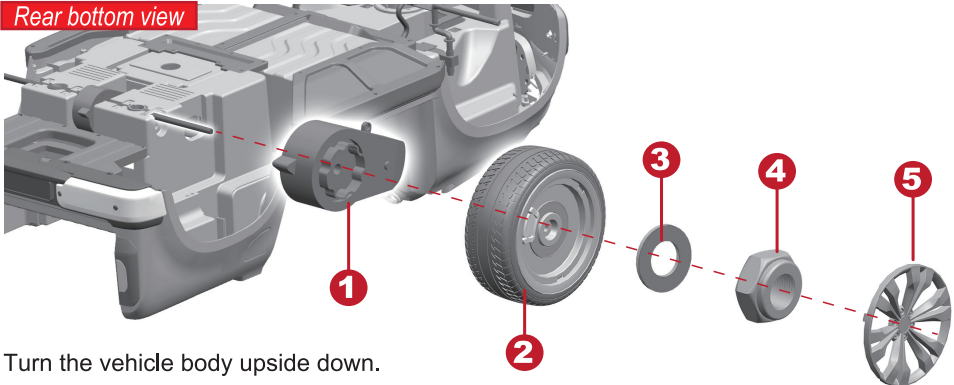

Turn the vehicle body upside down.

1. Slide the gear box onto the rear axle ("R" labeled gear box should be fit the "R" side of vehicle, and "L" labeled gear box should be fit the "L" side of vehicle), and keep the connector on the gear box pass through the hole on the vehicle.
2. Slide a driving wheel onto the rear axle.
3. Slide a  $\Phi 12$  washer onto the rear axle.
4. Tighten a lock nut to the end of the rear axle with a spanner.

Repeat for the other rear wheel.

**Hint:** An extra spanner has been provided to hold the lock nut on the other side of the rear axle while tightening the lock nut on the other side.

5. "Snap" the hubcap to the driving wheel.

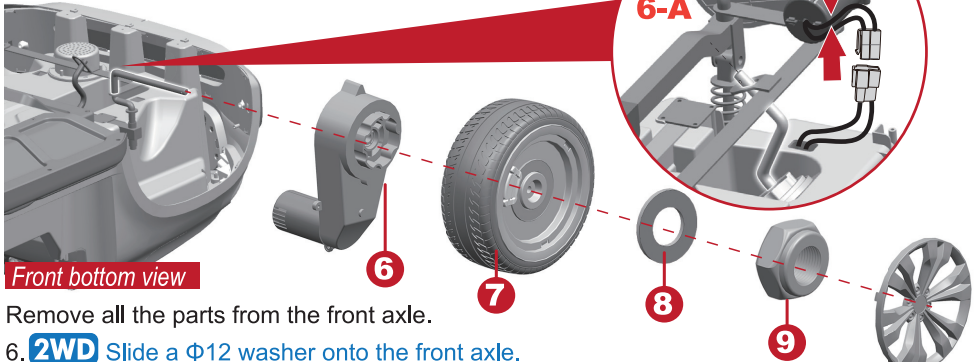

Front bottom view

Remove all the parts from the front axle.

6. **2WD** Slide a  $\Phi 12$  washer onto the front axle.

**4WD** Slide a gear box onto the front axle (Please fit the motor hood to the motor, refer to page 10). Plug the connector on the motor into connector on the vehicle body (6-A)

2. Slide a driving wheel onto the front axle.
  3. Slide a  $\Phi 12$  washer onto the front axle.
  4. Tighten a lock nut to the end of the front axle with a spanner.
  5. "Snap" the hubcap to the driving wheel.
- Repeat for the other front wheel.



*Rear view*

Turn the vehicle body over.

1. Fit the tabs on the trailer board into the slots on the rear of the vehicle.
2. Insert the two  $\Phi 4 \times 12$  screws and tighten with a screwdriver.
3. Fit the tabs on the rear support into the slots on the vehicle. push until you hear it "click" into place.
4. Fit the tabs on the roll bar into the slots on the vehicle. push until you hear it "click" into place.

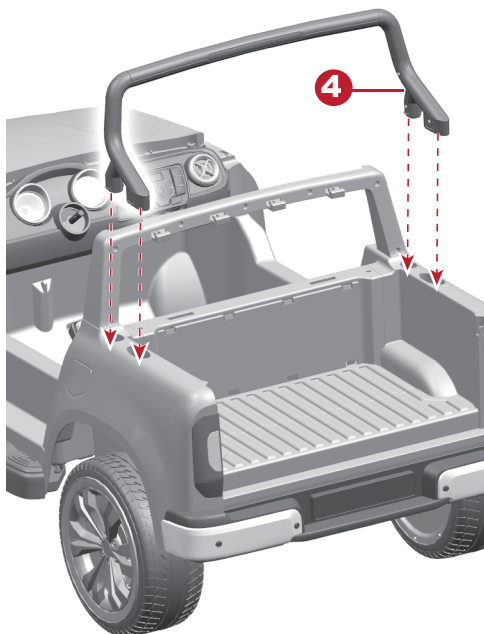
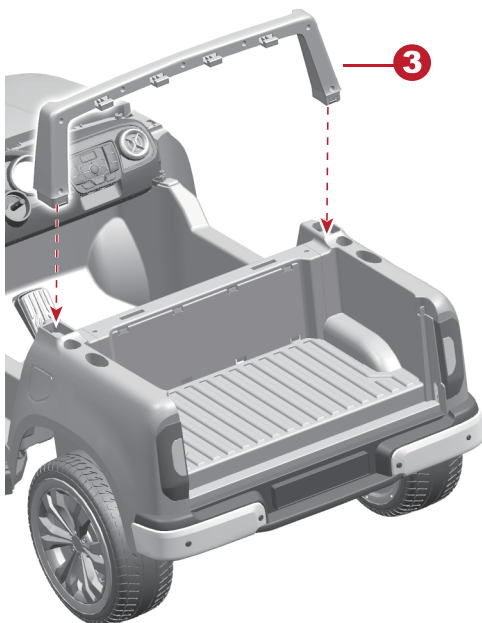
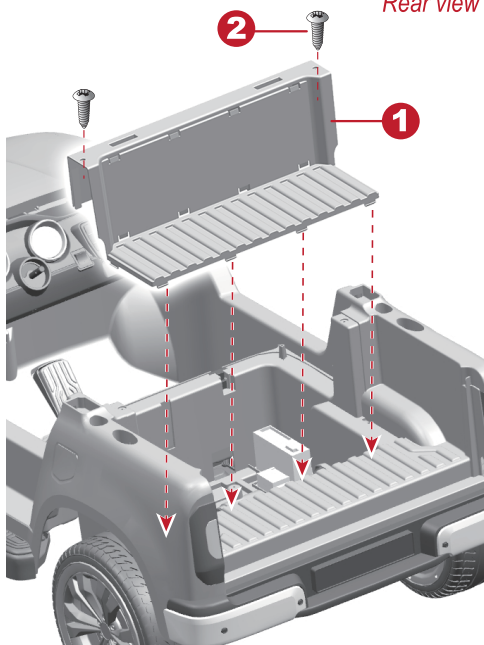

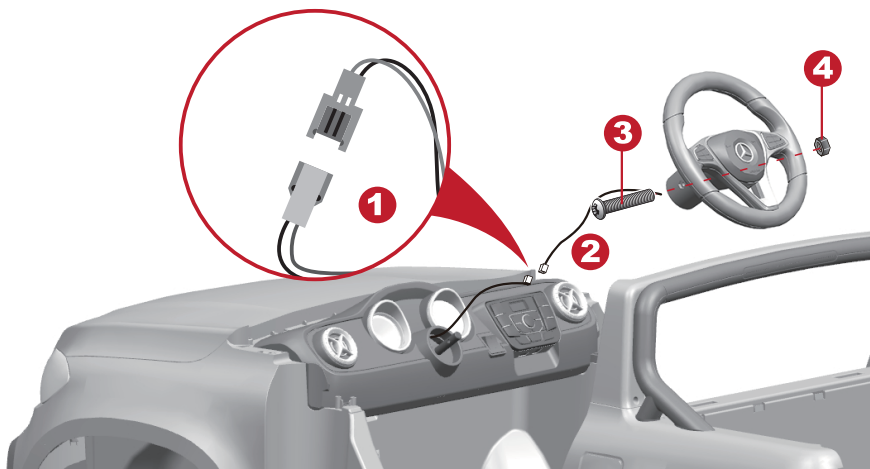

1. Plug the sound unit connector on the steering wheel into the connector on the vehicle body.
2. Fit the steering wheel to the end of the steering column.
3. Line up the holes on the steering wheel with the holes on the steering column, insert the M5x40 machine screw.
4. Fasten a nut on the opposite end of the screw with a screwdriver.
5. Insert the tabs on the windshield into the slots on the vehicle, push until you hear "click" into place.

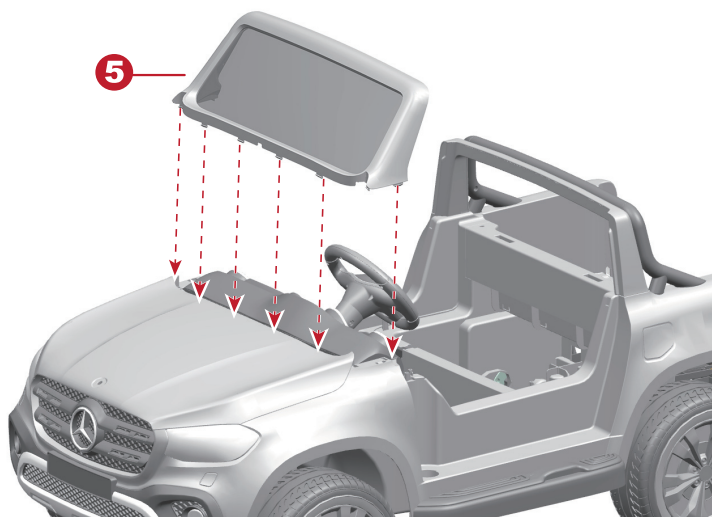



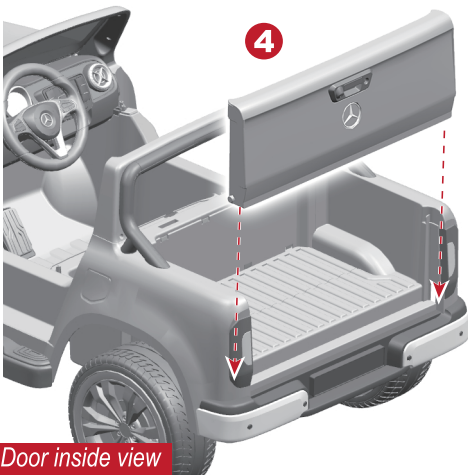
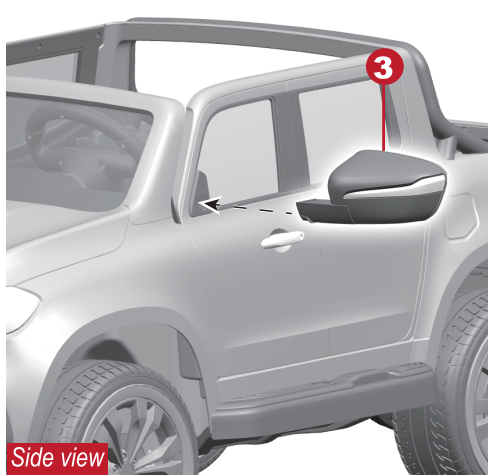
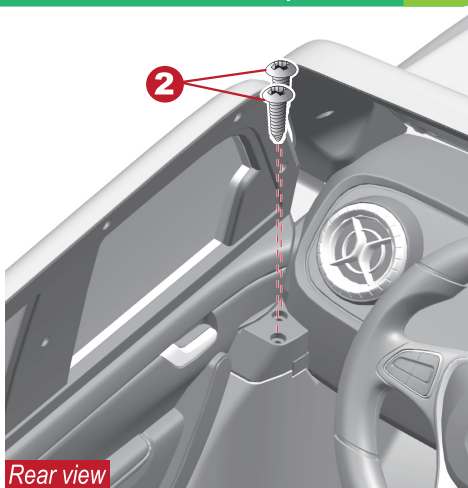
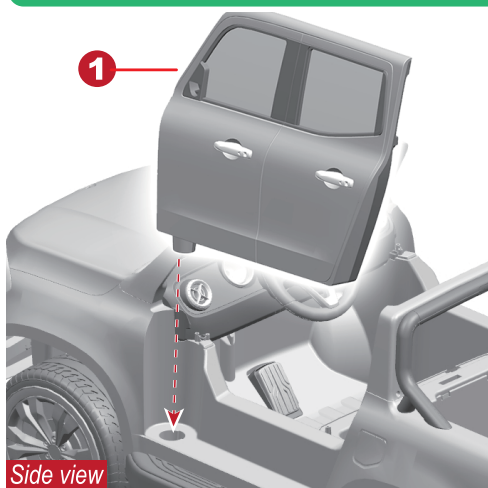

1. Fit the door to side of vehicle.
  2. Insert the two  $\Phi 4 \times 12$  screws pass through the door and into the vehicle body, tight them with a screwdriver. Repeat for the other door.
  3. Fit the tabs on the wing mirror into hole on door, push until you hear it “click” into place. Repeat for the other wing mirror.
  4. Fit the rear door to the rear of vehicle.
- Repeat for the other door.

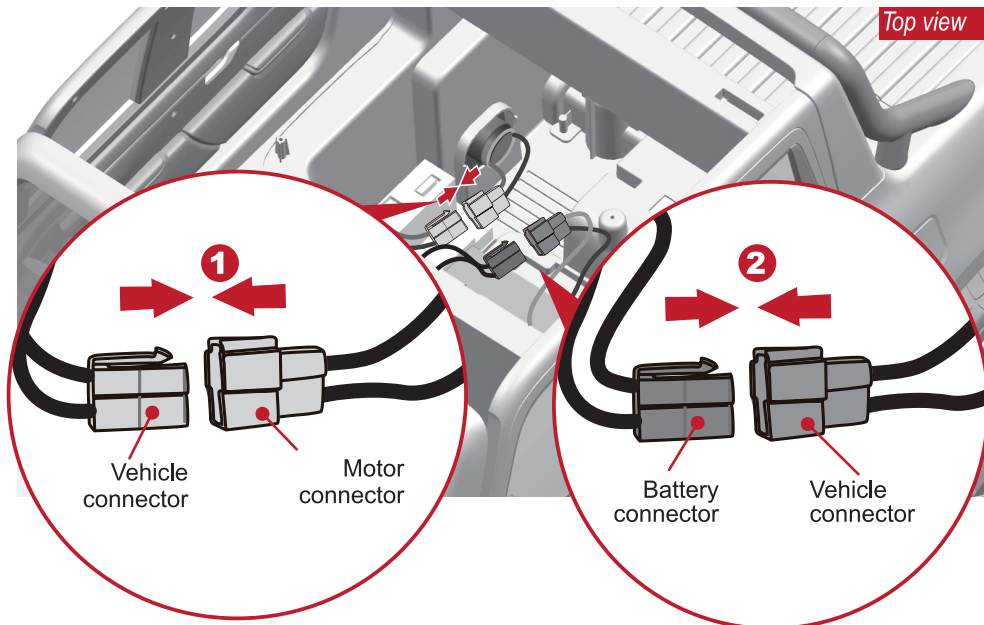

1. Plug the vehicle connectors into the motor connectors.
2. Plug the battery connector into the battery connector.
3. Insert the tabs on the back of seat into the slots on trailer board.
4. Insert two  $\Phi 4 \times 12$  screws and tighten.

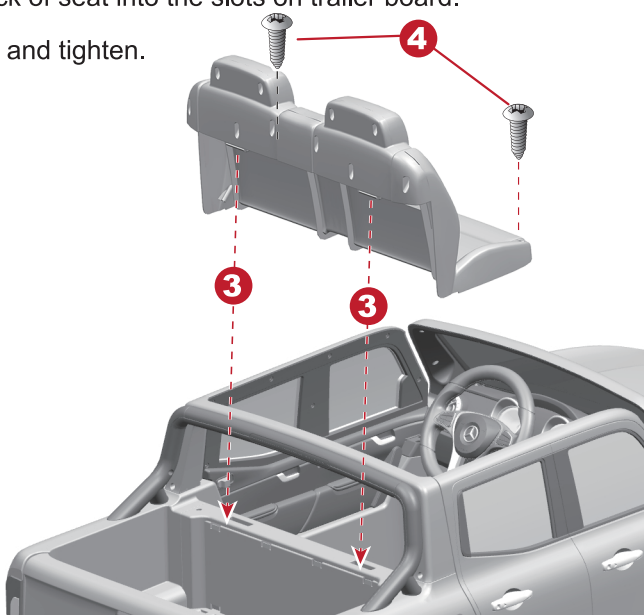

1. Rotate the pull handle out. The pull handle is below the trailer gate.
2. You may move the ride-on by pulling.

**4WD** Before using the pull handle, operates the vehicle to **2WD** mode. Avoid to damage the front motors.

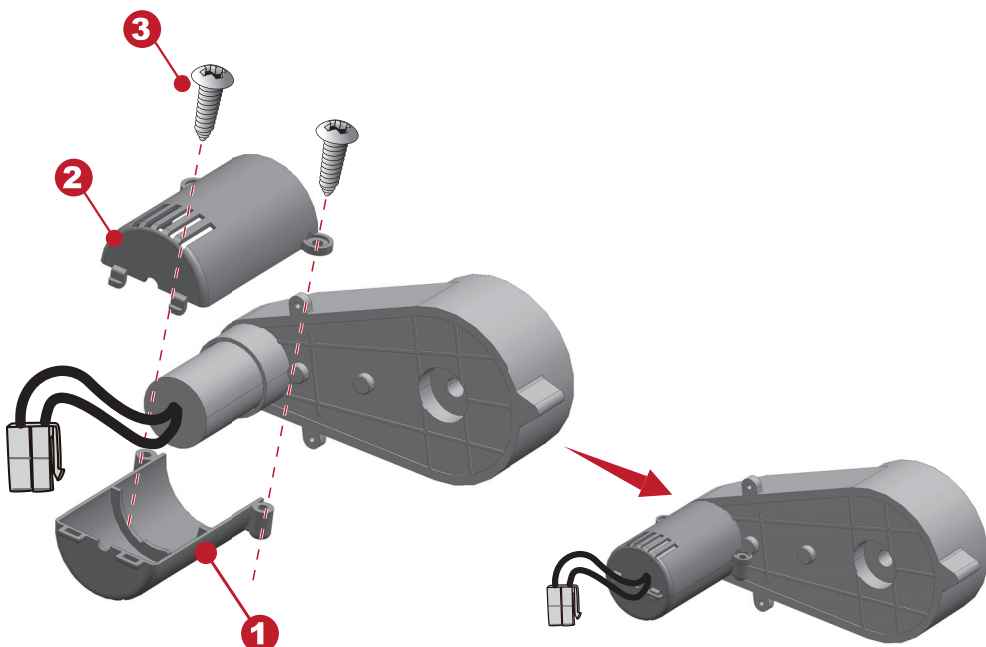
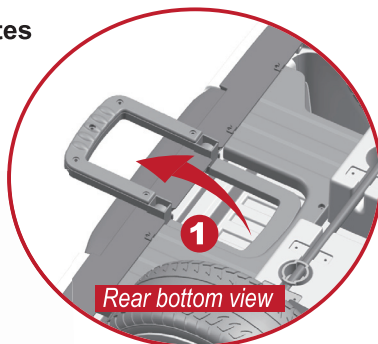

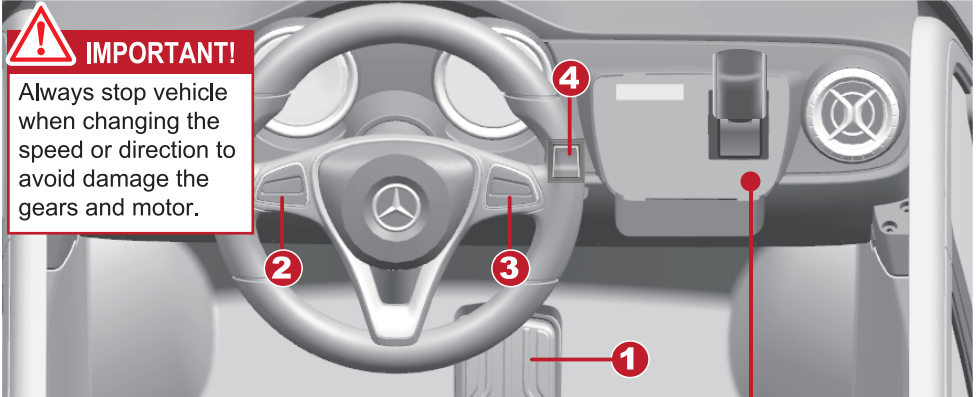

- 1. Foot pedal:** • To move the vehicle, press the pedal down.  
• To brake or slow down, release pressure from the pedal.

**2. Horn button:**

Press for horn playing

**3. Next / Increase volume button:**

Long press for + volume.

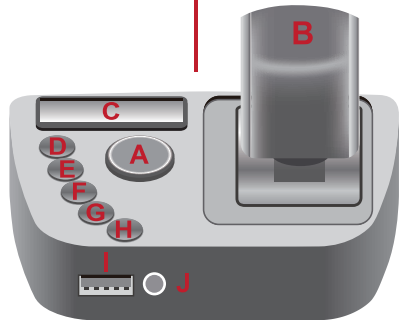

**A. Power Switch:** Turns the vehicle on and off.

**B. Forward/Reverse switch:**

Changes the direction that vehicle moves from forward to reverse. The vehicle equipped with 3 speeds in forward: high speed / normal speed / low speed.

**C. Display screen:** It displays the power level of the battery when the vehicle stops. When the numerical value is less than 12, recharge the battery please.

**D: Lights button:** Turns the lights on and off.

**E: Play / Pause**

**F. Previous / decrease volume**

**G. Next / Increase volume**

**H. Rocking mode**

**I. USB interface:** Allow the audio from your portable device to be played through the vehicle speakers. MP3 format ONLY.

**J. 3.5mm AUX input:** Allow the audio from your portable music player or phone to be played through the vehicle speakers. MP3 format ONLY.

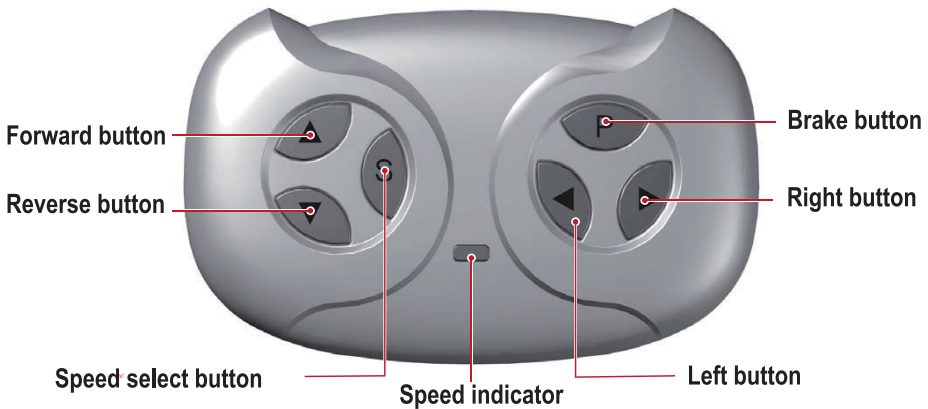

## Attach the batteries of controller

Lift the battery compartment door on the back of the controller and insert two AAA(LR03) batteries.

**HINT: Batteries not included. Refer to the Battery Information on the page 1.**

### 1. Build connection

Long press the forward and reverse buttons for 3 seconds, and the speed indicator flashes. Then power on the vehicle, the speed indicator goes to long bright, means the connection successful. If the speed indicator no response, means the connection failed. Replace the batteries and retry.

### 2. Brake button

Press the button to stop the vehicle, press it again to release the brake.

### 3. Speed select button

The switch operates the vehicle to move in low, normal or high speed.

**HINT: This switch won't work while your vehicle moves reverse.**

## NOTE:

- Leave the remote controller idling for about 10 seconds, it will shut down automatically.
- Rebuild connection when you replace the batteries of the remote controller.

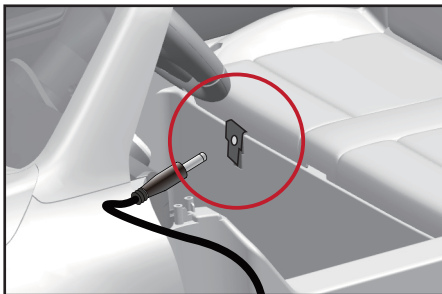

- The POWER SWITCH must be turned in **OFF** position when charging.
- After each use or once a month minimum recharge time as 8 to 12 hours, less than 20 hours at most.
- When the vehicle begins to run slowly, recharge the battery.
  1. Plug the charger port into the input socket. (below the seat)
  2. Plug the charger plug into a wall outlet. The battery will begin charging.



## WARNING!

This product with **Charging Protection**: when charging, all functions will be cut off! Only an adult can charge and recharge the battery!

## Maintaining

- It is parents' responsibility to check main parts of the toy before using, Must regularly examine for potential hazard, such as the battery, charge, cable or cord, plug, screws are fastening enclosure of other parts and that in the event of such damage, the toy must not be used until that damage had been properly removed.
- Make sure the plastic parts of the vehicle are not cracked or broken.
- Occasionally use a lightweight oil to lubricate moving parts such as wheels.
- Park the vehicle indoors or cover it with a tarp to protect it from wet weather.
- Keep the vehicle away from sources of heat, such as stoves and heaters. Plastic parts may melt.
- Recharge the battery after each use. Only an adult can handle the battery. Recharge the battery at least once a month when the vehicle Raider is not being used.
- Do not wash the vehicle with a hose. Do not wash the vehicle with soap and water. Do not drive the vehicle in rainy or snowy weather. Water will damage the motor, electric system and battery.
- Clean the vehicle with a soft, dry cloth. To restore shine to plastic parts, use a non-wax furniture polish. Do not use car wax. Do not use abrasive cleaners.
- Do not drive the vehicle in loose dirt, sand or fine gravel which could damage the moving parts, motors or the electric system.
- When not using, all the electrical source should be turn off. Turn off the power switch and disconnect the battery connection.



Problem	Possible Cause	Solution
Vehicle does not run	Battery low on power	Recharge battery.
	Thermal fuse has tripped	Reset fuse, see <Fuse>
	Battery connector or wires are loose	Check that the battery connectors are firmly plugged into each other. If wires are loose around the motor <b>contact your distributor please.</b>
	Battery is dead	Replace battery, <b>contact your distributor please.</b>
	Electrical system is damaged	<b>Contact your distributor please.</b>
	Motor is damaged	<b>Contact your distributor please.</b>
Vehicle does not run very long	Battery is under charged	Check that the battery connectors are firmly plugged into each other when recharging
	Battery is old	Replace battery, <b>contact your distributor please.</b>
Vehicle runs sluggishly	Battery low on power	Recharge battery, <b>contact your distributor please.</b>
	Battery is old	Replace battery, <b>contact your distributor please.</b>
	Vehicle is overload	Reduce weight on vehicle. Maximum user weight is 50 kg.
	Vehicle is being used in harsh conditions	Avoid using vehicle in harsh conditions ,see <Safety>.
Vehicle needs a push to go forward	Poor contact of wires or Connectors	Check that the battery connectors are firmly plugged into each other. If wires are loose around the motor, <b>contact your distributor please.</b>
	"Dead Spot" on motor	A dead spot means the electric power is not being delivered to the terminal connection and the vehicle needs repair. <b>Contact your distributor please.</b>
Difficult shifting from forward to reverse or vice-versa	Attempting to shift while the vehicle is motion	Completely stop the vehicle and shift, see <Use Your New Vehicle>
Loud grinding or clicking noises coming from motor or gear box	Motor or gears are damaged	<b>Contact your distributor please.</b>
Battery will not recharge	Battery connector or adapter connector is loose	Check that the battery connectors are firmly plugged into each other.
	Charger not plugged in	Check that the battery charger is plugged into a working wall outlet.
	Charger is not working	<b>Contact your distributor please.</b>
Charger feels warm when recharging	This is normal and not a cause for concern	

Completely read through this manual and the troubleshooting guide table before calling. If you still need help resolving the problem **Contact your distributor please.**



## Disposal Of Battery



- Your sealed lead-acid battery must be recycled or disposed of in an environmentally sound manner.
- Do not dispose of your lead-acid battery in a fire. The battery may explode or leak.
- Do not dispose of a lead-acid battery in your regular, household trash. The incineration, land filling or mixing of sealed lead-acid batteries with household trash is prohibited by law.

Our products are suitable for ASTM F963; GB6675; EN71 and EN62115 standard.