



## **AUDI Q5 - OFFICIAL LICENSED PRODUCT BATTERY-POWERED RIDE-ON**

# **Owner's Manual with Assembly Instructions**

Styles and colors may vary.

Made in China.

The owner's manual contains important safety information as well as assembly, use and maintenance instructions.

The Battery-powered Ride-on Car must be assembled by an adult who has read and understands the instructions in this manual.

Keep the package away from children and dispose of properly before use.

Keep this manual for future reference.

Thank you for the purchase of your new AUDI Licensed Ride-On.  
This ride-on car will provide your child with many miles of riding of enjoyment. To help assure you and your rider a safe ride, we ask you to please read this manual carefully, and keep it for future reference.

Follow the recommendations in this manual, they are designed to improve the safety and operation of your Battery-powered ride-on car and its rider.

Officially Licensed by AUDI AG

Audi Q5 Ride On

Audi Q5 Electric Ride-on manufactured by Jiaxing Xuma Ride On Co., Ltd.

(Address: Minzhu Village, Guangchen Town, Pinghu City, Zhejiang Province, P.R.China).

Trademarks, design patents and copyrights are used with the approval of the owner AUDI AG .

## Owner's Manual Index

### Safety

- Charging the Battery Warnings.....4
- User Requirements.....4

### Assembly

- Parts View.....5
- Parts List.....6
- Attach the Driving Wheel.....7
- Attach the Rear Left Wheel.....7
- Attach the Front Normal Wheels.....8
- Installing the Mirrors.....9
- Assembly - Connect the power supply.....10
- Assembly - Installing the Seat.....10

### Operation

- Operation and Features.....11
- Charging Your Vehicle.....11

### Maintenance and Service

- General.....12
- Battery.....12
- Re-charge Interval and Time.....12
- Battery Storage.....12
- Battery Replacement and Disposal.....12
- Battery Fuse.....12
- Troubleshooting Guide.....13

# Safety

## ⚠️WARNING!

The user must follow all safety rules and guidelines below or serious injury or death may occur to the user.

- Always use common sense and safe practices when using the vehicle. The user must be three years old and up, and weight no more than 66 lbs (30kgs).
- This product contains small parts that are for adult assembly only. Keep small children away when assembling. Remove and dispose of all protective material and polybags before assembly. Be sure to remove all packaging materials and parts from underneath the car body.
- Body parts such as hands, legs, hair and clothing can get caught in moving parts. Never place a body part near a moving part or wear loose clothing while using the vehicle. Always wear shoes when using vehicle.
- Using the vehicle near streets, motor vehicles, drop-offs such as: steps, water (swimming pools), sloped surfaces, hills, wet areas, flammable vapors, in alleys, at night or in the dark could result in an unexpected accident. Always use the vehicle in a safe, secure environment with continuous adult supervision.
- Do not use the vehicle in unsafe conditions such as snow, rain, loose dirt, mud sand or fine gravel. This may result in unexpected action such as tip over and skidding.
- Do not use the vehicle in an unsafe manner. Examples include but are not limited to:
  1. Pulling the vehicle with another vehicle or similar device.
  2. Allowing more than one rider.
  3. Pushing the user from the back.
  4. Traveling at an unsafe speed.
- This toy is unsuitable for children under 3 years due to its maximum speed.
- There are additional hazards of using the toy in areas other than private grounds.
- Not to be used in traffic.
- The toy shall be used with caution since skill is required to avoid falls or collisions causing injury to the user and third parties.
- Not suitable for children under 36 months due to "small parts".

# Charging the Battery Warnings

## ⚠️WARNING!



The following safety hazards may result in serious injury or death to the user of the vehicle:

- Use of a battery or charger other than the supplied rechargeable battery and charger may cause a fire or explosion. Only use the supplied rechargeable battery and charger with the vehicle.

- Using the rechargeable battery and charger for any other product may result in overheating, fire or explosion.

Never use the rechargeable battery and charger with another product.

- Gases can be created during charging. Charge the battery in a well ventilated area.

Do not charge the battery near heat or flammable materials.

- Contact between the positive and negative terminals may result in fire or explosion. Avoid direct contact between the terminals. Picking up the battery by the wires or charger can cause damage to the battery and may result in a fire.

Always pick up the battery by its case or handles.

- Liquids on the battery may cause fire or electric shock. Always keep all liquids away from the battery and keep the battery dry.

- Contact or exposure to battery leakage (lead acid) may cause serious injury. If contact or exposure occurs immediately call your physician. If the chemical is on the skin or in the eyes, flush with cool water for 15 minutes. If the chemical was swallowed, immediately give the person water or milk. Do not give water or milk if the patient is vomiting or has a decreased level of alertness.

Do not induce vomiting.

- Tampering or modifying the electric circuit system may cause a shock, fire or explosion and permanently damage the system. Exposed wiring, circuitry in the charger may cause electric shock.

Always keep the charger housing closed.

**Important!** Before using the BMW for the first time the battery needs to be charged for a full twelve hours. Only an adult who has read and understands the following safety warnings should handle, charge or recharge of the battery (see Maintenance).

**Note:** It is not necessary to remove the battery from the vehicle for charging. However, if the adapter cord will not safely reach a 110V wall outlet, the battery can be removed for charging (see page 12 for instructions concerning battery replacement).

# User Requirements

The suitable age range for a child using the AUDI Ride-on Car is three years old and up. The maximum weight of the child is 66 lbs (30 kg).

Before using the AUDI Ride-on Car the child must understand the vehicle controls and safety issues.

They must also demonstrate the capability to handle the vehicle and operate its controls.

It is the responsibility of the adult to educate the child, determine if they are fit to operate the vehicle, and supervise the vehicle's use.

Here are basic safe riding rules you should explain fully to your child and anyone who may ride the AUDI Ride-on Car:

- An adult must always supervise a child who is riding the vehicle.
- Always sit in the seat when using the vehicle.
- Keep your hands, hair and clothes away from moving parts. Always wear shoes when riding in the vehicle.
- Do not drive the vehicle on streets or near cars.
- Children under three years old should not be allowed to use the vehicle.
- Only drive on level ground. Don't go near water, drop-offs or up and down steep slopes.
- Don't drive the vehicle into loose dirt, mud, sand or fine gravel. Driving the vehicle into loose dirt, mud, sand, or fine gravel may damage the electronics and gear box inside the vehicle.

# Parts View

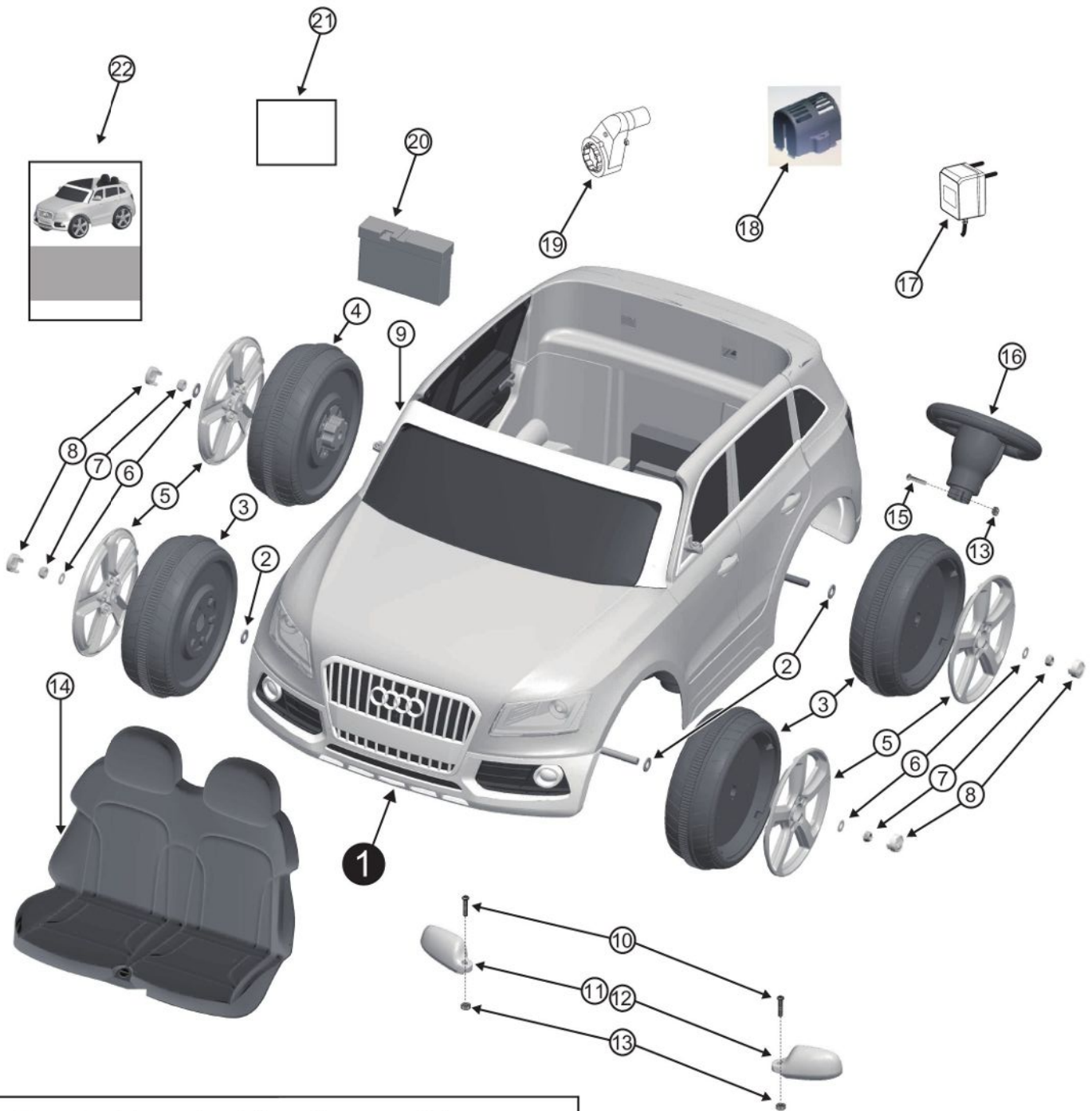

## Tools Needed for Assembly:



Screwdriver (not provided)



Spanner (supplied)

## Parts List

NO.	Descrip on
1	Body
2	Ø12 washer (x3)
3	Normal Wheel (x3)
4	Driving Wheel
5	Wheel Trim(x4)
6	Ø10 washer (x4)
7	Locknut (x4)
8	Hubcaps (x4)
9	Windshield
10	M5*22 Screw Bolt(x2)
11	Mirror, Right
12	Mirror, Left
13	Nut(x3)
14	Seat
15	M5*52 Screw Bolt
16	Steering Wheel
17	Charger
18	Motor Cover
19	Motor Gear
20	Battery
21	Spare hardware package
22	Manual

## Installation steps

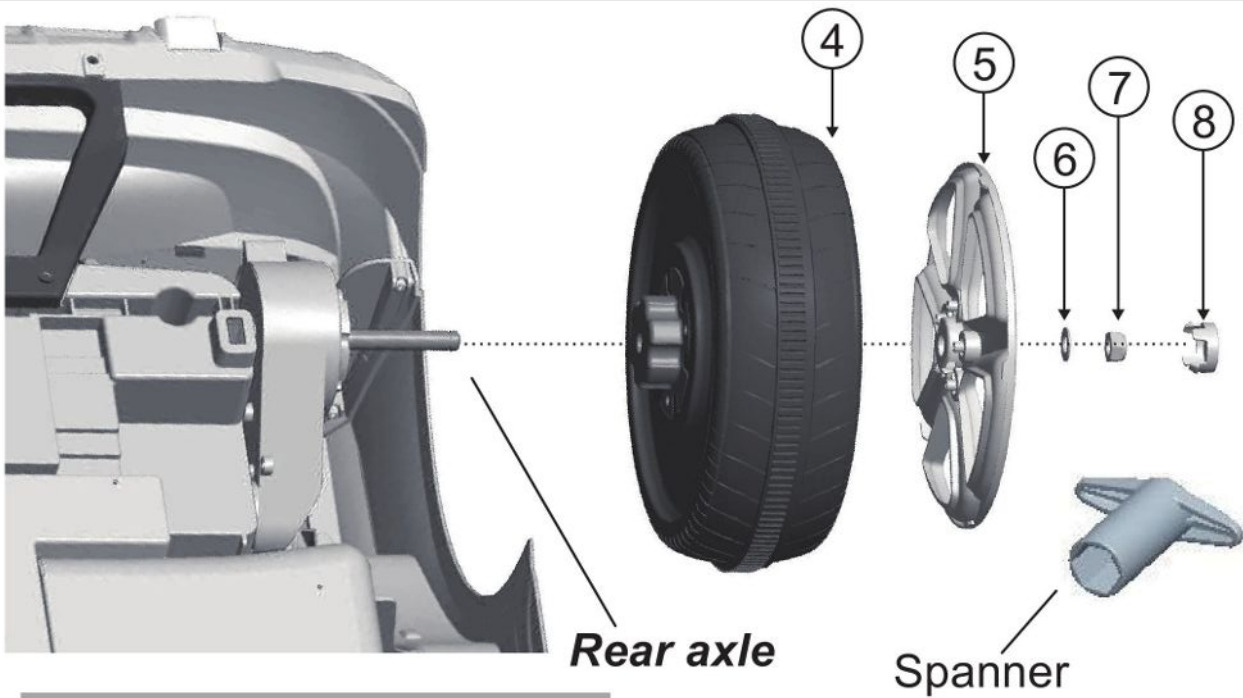

### Attach the Driving Wheel

1. Slide the **driving wheel** onto the rear axle(right side). And keep the **driving wheel** match with the **Motor Gear** inserted.
2. Slide the wheel trim and **Ø10 Washer** onto the **rear axle**.
3. Tighten the **Ø10 Locknut** to the end of the **rear axle** with a spanner.
4. Align the two tabs of the hubcap with the slots of the wheel trim, then press the hubcap into places.

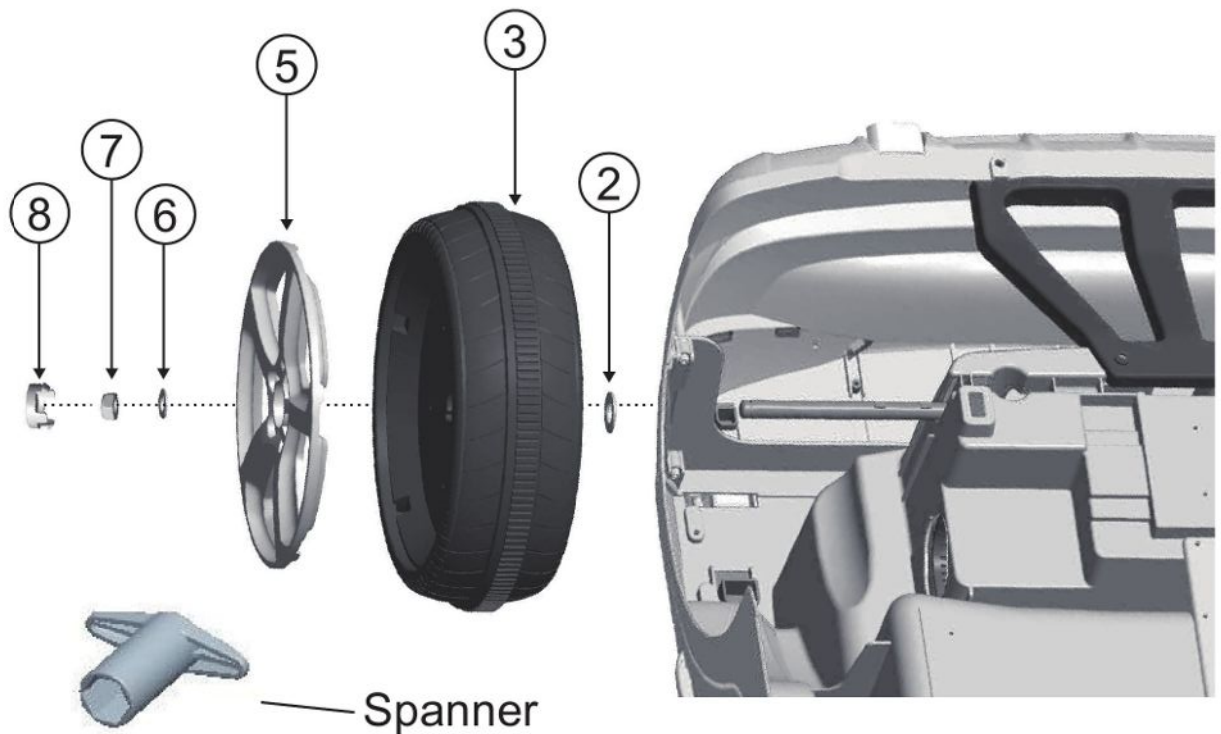

### Attach the Rear Left Wheel

1. Slide the **Ø12 washer** and **Normal wheel** onto the rear axle (left side).
2. Slide the wheel trim and **Ø10 Washer** onto the **rear axle**.
3. Tighten the **Ø10 Locknut** to the end of the **rear axle** with a spanner.
4. Align the two tabs of the hubcap with the slots of the wheel trim, then press the hubcap into places.

## Installation steps

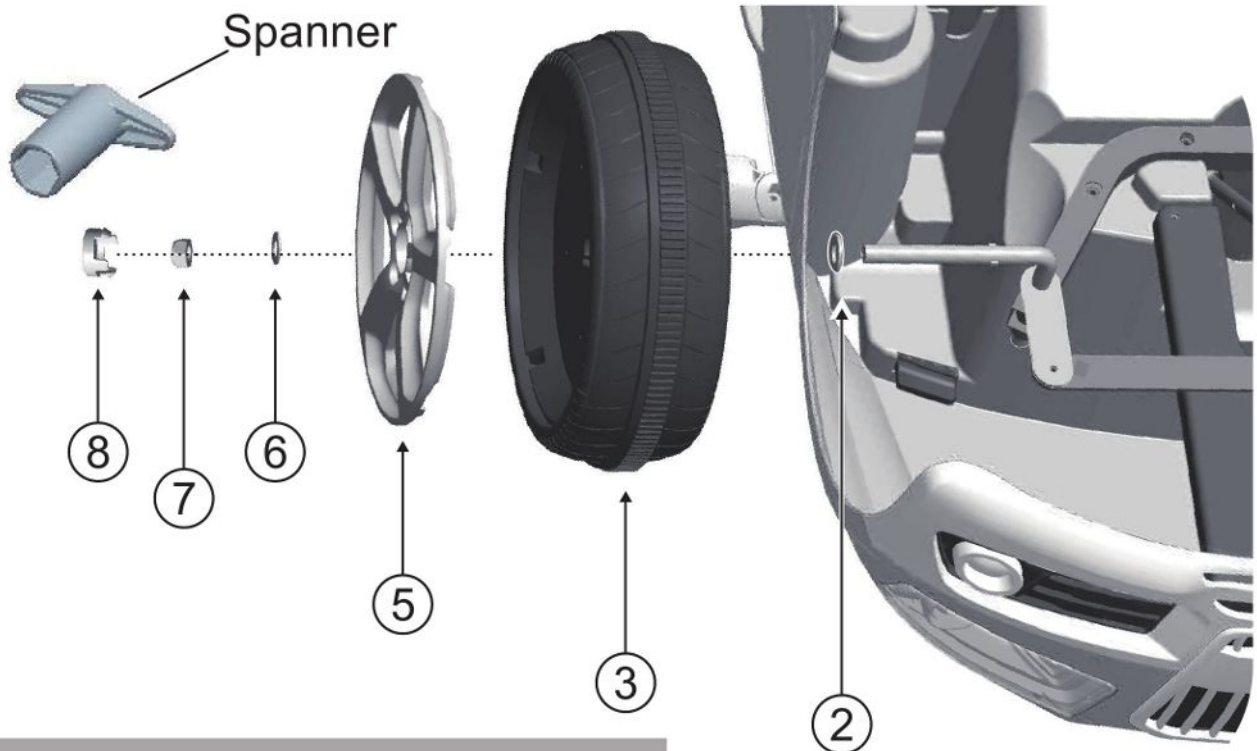

### Attach the Front Normal Wheels

1. Slide the  $\varnothing 12$  washer and Normal wheel onto the front axle (left side).
  2. Slide the wheel trim and  $\varnothing 10$  Washer onto the front axle.
  3. Tighten the  $\varnothing 10$  Locknut to the end of the front axle with a spanner.
  4. Align the two tabs of the hubcap with the slots of the wheel trim, then press the hubcap into places.
- Repeat the above steps for the other front wheel.

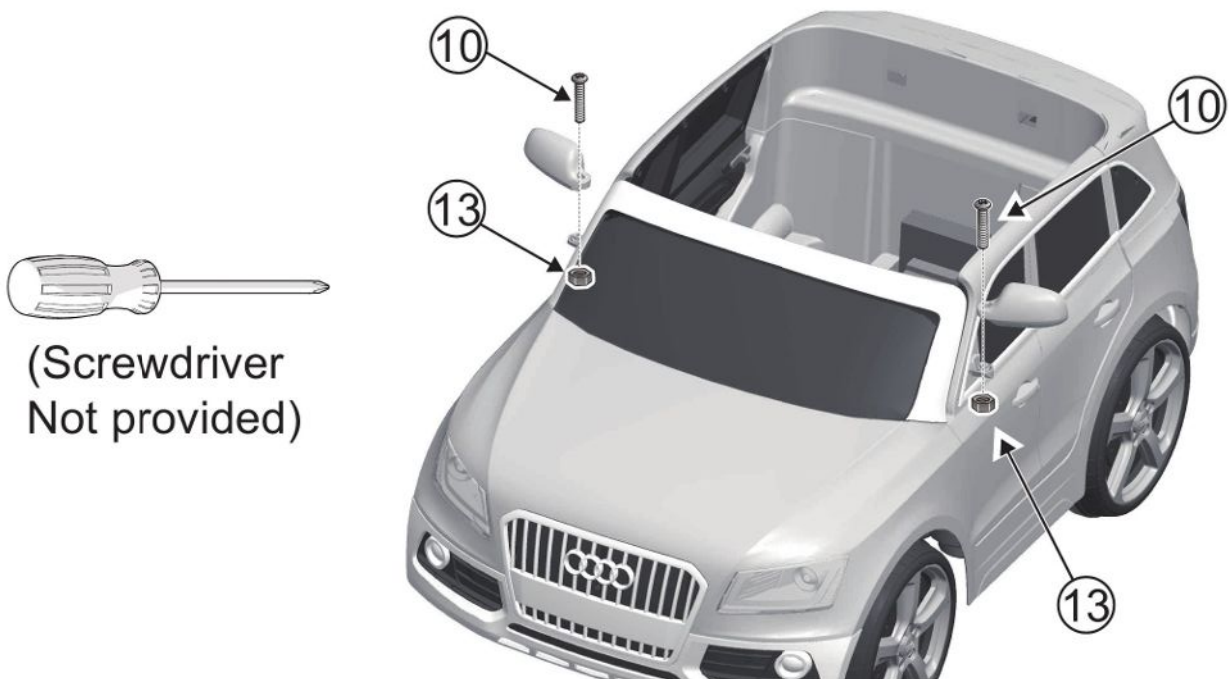

(Screwdriver  
Not provided)

### Installing the Mirrors

1. Insert the mirror into the slots of the mirror bracket located on the body
2. Insert a screw bolt through the top of the hole in the mirror and mirror bracket (a nut inside the mirror bracket)
3. Fasten the screw bolt and nut with screwdriver.
4. Repeat the above steps for the remaining mirror.



# Installation steps



(Screwdriver  
Not provided)

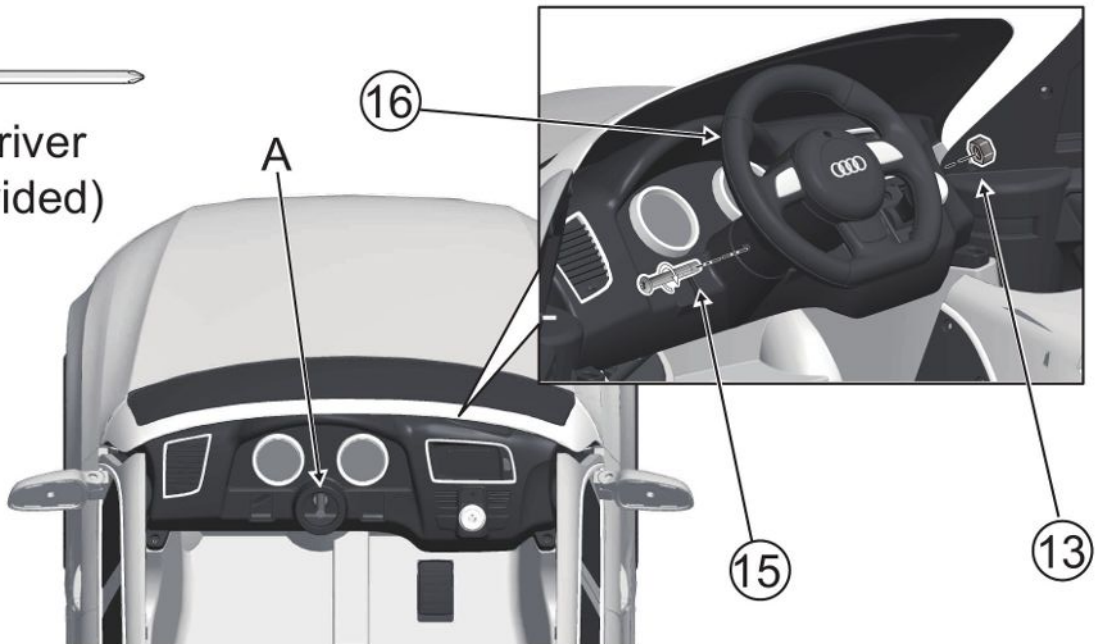

## Installing Steering Wheel

1. Remove the screw bolt from the steering wheel.
2. Place the steering wheel over the steering column (A).
3. Align the hole on each side of steering wheel with the hole at the end of the steering column (A).
4. Insert the screw bolt through the steering wheel and steering column (A) into the nut. Tighten it securely.

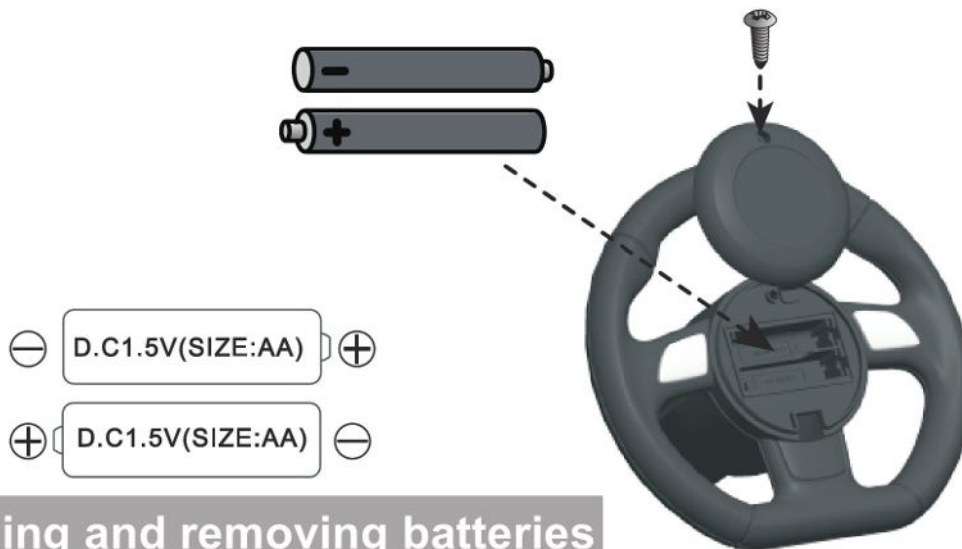

## Installing and removing batteries

If you wish to use the sounds, install two AA batteries (not provided) using the following steps:

5. Use the screwdriver to remove the screw on the battery compartment cover located in the center of the steering wheel.
6. Remove the battery compartment cover from the top of the battery compartment.
7. Insert two AA batteries oriented as shown in the battery tray.
8. Place the battery compartment cover over the battery compartment and fasten the screw removed above.
9. Remove the screw on the battery compartment cover, and take off the cover. Remove and replace the AA batteries.

## WARNING!

- Batteries must be installed by Adult;
- Non-rechargeable batteries are not to be recharged;
- Different types of batteries or new and used batteries are not to be mixed;
- Batteries are to be inserted with the correct polarity;
- Exhausted batteries are to be removed from the toy;
- The supply terminals are not to be short-circuited;
- Rechargeable batteries are only to be charged under adult supervision;
- Rechargeable batteries are to be removed from the toy before being charged.

## Installation steps

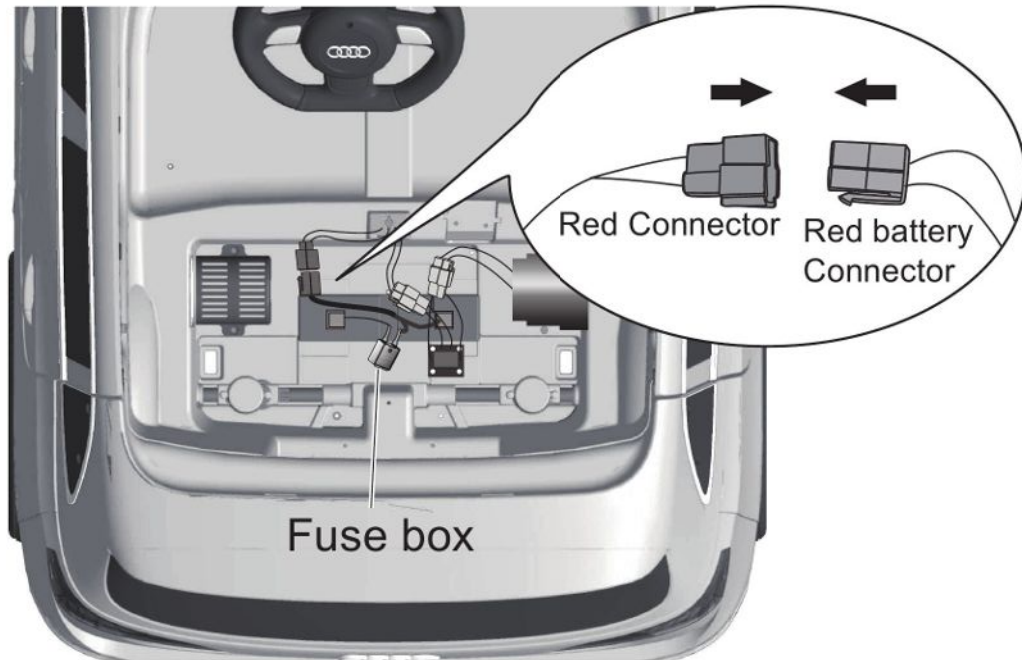

### Assembly - Connect the power supply

Plug the red battery connector into the red connector on body as shown.

#### ⚠ WARNING!

Connect the red to red connectors, and white to white connectors.  
Connecting incorrectly can damage the battery and/or motor, may cause other hazard problem.

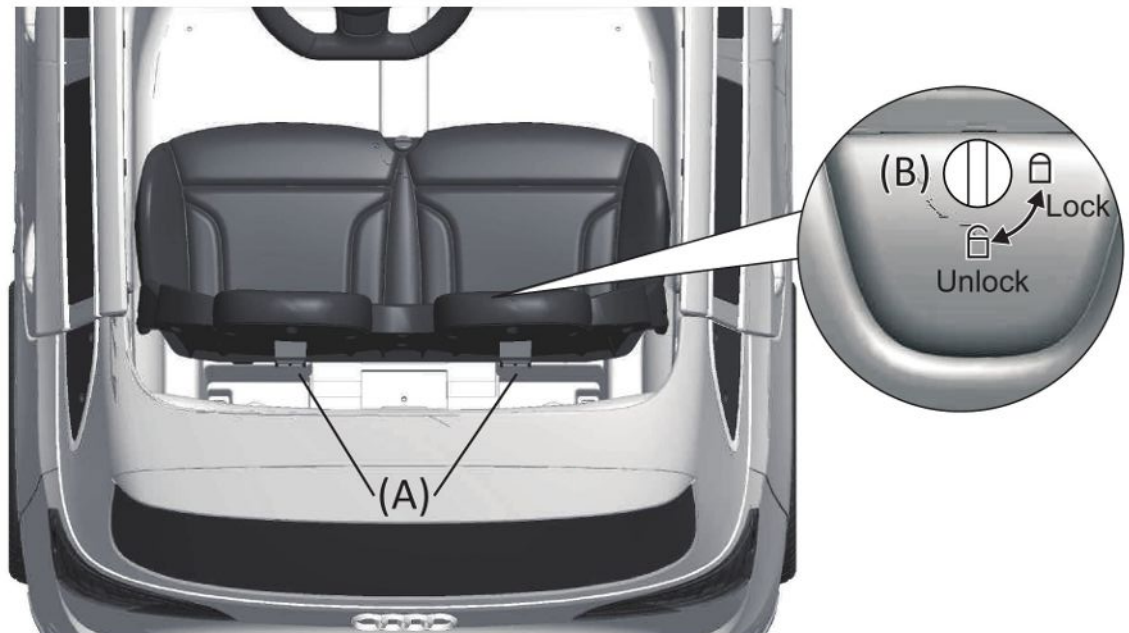

### Assembly - Installing the Seat

1. Align the Tabs (A) on the back of the seat with the slots in the back of the main body.
2. Align the Lock on the front of the seat with the hole in the middle of the main body. Be sure the lock is orientated so it will fit into the slot.
3. Rotate and lower the seat onto the main body. Ensure the seat tabs stay in the slots and the Lock (B) into the main body hole.
4. Using a coin or screwdriver turn the Lock on the front of the seat to secure the seat to the main body.

**CAUTION:** Ensure no wires or connectors are pinched under the seat.

# Operation and Features



## • FORWARD

1. Press the "Forward/stop/reverse switch" on the "Forward" position.
2. Press the "Foot pedal", the vehicle drives forward.

## • REVERSE

1. Press the "Forward/stop/reverse switch" on the "reverse" position.
2. Press the "Foot Pedal", the vehicle will back up.

## • STOP

The vehicle will brake automatically, when your child's foot is lifted from the "Foot pedal".

Note: Press the "Forward/stop/reverse switch" on the middle "stop" position, the vehicle will not move.

## • SOUND BUTTONS:

Press the buttons on the sides of the steering wheel. Each button will make a different sound effect.

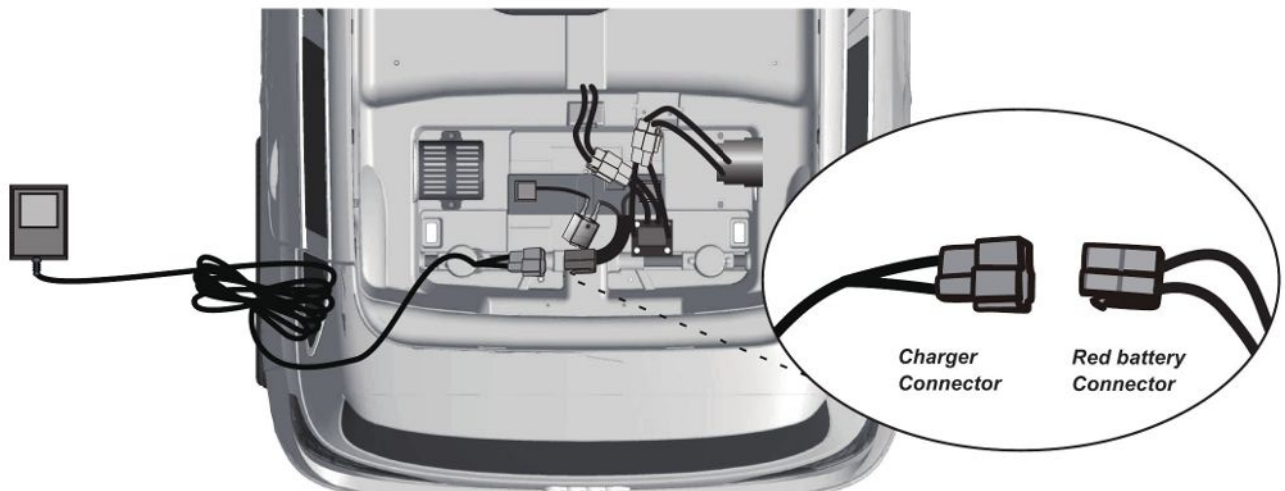

## Charging Your Vehicle

**NOTE:** Before first use, charge battery 12 to 15 hours.

1. Ensure the power switch is off. Remove the seat (Refer the seat section), use a coin or screwdriver to unlock the Lock in front middle of the seat.
2. Unplug the red battery connector: Push the connectors fully together, then press in the locking clip. Then pull connectors apart.
3. Plug the Charger connector into the red battery connector (Only use the 6V charger included with the vehicle, input: AC 230V, 50/60 Hz output: DC 6V), Plug the charger into a standard 230V wall outlet.
4. After charging is complete (at least 8 hours, but not more than 12 hours.)
5. Unplug the charger from the wall outlet.
6. Unplug the charger connector from the red battery connector.
7. Reconnect red connectors.
8. Replace seat (see Seat section).

**CAUTION:** Ensure no wires or connectors are pinched under the seat when reinstalling.

**NOTE:** The charger may feel warm during the charging. This is normal and not a cause for concern. If excessively hot, unplug and replace.

# Maintenance

## General

The vehicle should be checked for damage, missing or badly worn parts before use.

- Check the tightness of the fasteners before each use.
- Check the tightness of the wheel. Use a flat head screwdriver to gently pry off the hubcaps. Note: If the wheel is not tight, the wheel will not engage the forward gears and the vehicle will not run.
- Ensure the battery bracket is securely in place before use.
- Occasionally use lightweight oil to lubricate moving parts such as wheels and steering linkage. Do not use oil on plastic or nylon parts. No lubrication is required.
- Store the vehicle indoors. Keep it away from sources of heat, such as stoves and heaters.
- Clean the vehicle with a soft, dry cloth. To restore shine to plastic parts, use a non-wax furniture polish. Do not use car wax, abrasive cleaners or wash the vehicle with soap and water. Water will damage the motor, electrical system and battery.

## Battery

Only an adult who has read and understands the safety warnings (see Assembly) should handle charge or recharge of the battery. Failure to comply with the following safety warnings may result in serious injury or death.

## Re-charge Interval and Time

### Important!

- Damage to the battery may occur if it is allowed to drain completely. Do not allow the battery to drain completely.
  - Check the battery and charger (supply cord, connector) for wear and damage before charging. Do not charge the battery if damage has occurred. Only replace with a 6V rechargeable battery and charger supplied by the manufacturer.
  - Only use the rechargeable battery (or equivalent replacement) and charger supplied with your vehicle.
  - Before first use, charge battery 15 to 18 hours - never longer than 18 hours.
  - Once battery is depleted, recharge for 8 to 12 hours - never longer than 12 hours.
  - Do not short circuit the battery: DO NOT connect red and black wires together or connect positive and negative terminals on the battery together.
  - When battery is fully charged, un-plug charger from the wall outlet and disconnect from charger port.
- Failure to charge the battery as directed will cause permanent damage to the battery and will void the warranty.

## Battery storage

Do not leave the battery connected in the vehicle for long period of times while not being used. This may drain the battery completely and cause permanent damage. Disconnect the battery connectors from the battery if the vehicle is not going to be used for a long period of time.

Follow these guidelines if the battery is removed:

- Store the battery where temperatures are between -15 °C and 50 °C.
- Store the battery on a wood surface. Do not place the battery on cement floors for extended periods. This will result in battery discharge.
- Wipe the battery clean with a dry cloth prior to storage.

## Battery Replacement and Disposal

The 6V battery will eventually lose the ability to hold a charge. Depending on the amount of use, and varying conditions, the battery should operate for one to three years. Follow these steps to replace and dispose the battery:

1. Remove the car seat.
2. Disconnect the battery connectors.
3. Remove the metal battery bracket.
4. Carefully lift the battery. Depending on the condition of the battery (i.e.: leakage) you may want to wear protective gloves before removal. Do not lift the battery by its connectors or cables.
5. Place the dead battery in a plastic bag.

**Important!** Recycle the dead battery responsibly. The battery contains lead acid (electrolyte) and must be disposed of properly and legally. It is illegal in most areas to incinerate lead acid batteries or dispose of them in landfills. Take it to a approved lead acid battery recycler, such as local automotive battery retailer. Do not throw the battery away with your regular household waste!

6. Replace the battery and reconnect the connectors.
7. Replace the metal battery bracket.
8. Replace the seat.

## Battery Fuse

The 6V battery features a thermal fuse with a reset fuse that will automatically trip and cut all power to the vehicle if the motor, electric system or battery is overloaded. The fuse will reset and power will be restored after the unit is turned OFF for five Minutes and then turned ON again. If the thermal fuse trips repeatedly during normal use, the vehicle may need repair. Call local Consumer Relations.

To avoid losing power, follow these guidelines: Do not overload the vehicle. Do not tow anything behind the vehicle. Do not drive up steep slopes. Do not drive into fixed objects, which may cause the wheels to spin, causing the motor to overheat. Do not drive in very hot weather, components may overheat. Do not allow water or other liquids to come in contact with the battery or other electric components. Do not tamper with the electric system. Doing so may create a short, causing the fuse to trip.

# Troubleshooting Guide

The following are examples of potential problems. Completely read through this manual and the troubleshooting guide table before calling. If you still need help resolving the problem please call local Consumer Relations.

<b>Problem</b>	<b>Possible Cause</b>	<b>Remedy</b>
Vehicle does not run	Battery low on power	Recharge battery (see Battery: Recharge interval and time)
	Thermal fuse has tripped	Reset fuse (see Maintenance: General)
	Battery connector or wires are loose	Check that the battery connectors are firmly plugged into each other. If wires are loose around the motor call local Consumer Relations.
	Battery is dead	Replace battery (see Battery: Replacement and Disposal)
	Electrical system is damaged	Call local Consumer Relations.
	Motor is damaged	Call local Consumer Relations.
Vehicle does not run very long	Battery is under charged	Check that the battery connectors are firmly plugged into each other when recharging (see Battery: Recharge interval and Time)
	Battery is old	Replace battery (see Battery: Replacement and Disposal)
Vehicle runs sluggishly	Battery low on power	Recharge battery (see Battery: Recharge interval & time)
	Battery is old	Replace battery (see Battery: Replacement and Disposal)
	Vehicle is overloaded	Reduce weight on vehicle (see user requirements and Safety Warnings)
	Vehicle is being used in harsh conditions	Avoid using vehicle in harsh conditions (see User Requirements and Safety Warnings)
Vehicle needs a push to go forward	Poor contact of wires or connectors	Check that the battery connectors are firmly plugged into each other. If wires are loose around the motor call local Consumer Relations.
	"Dead Spot" on motor	A dead spot means the electric power is not being delivered to the terminal connection and the vehicle needs repair. Call local Consumer Relations.
Loud grinding or clicking noises coming from motor or gear box	Motor or gears are damaged	Call local Consumer Relations.
6V Battery will not recharge	Battery connector or adapter connector is loose	Check that the battery connectors are firmly plugged into each other.
	Charger not plugged in	Check that the battery charger is plugged into a working wall outlet.
	Charger is not working	Call local Consumer Relations.
Charger feels warm when recharging	This is normal and not a cause for concern. If excessively hot, unplug and replace.	