

Charging The Vehicle

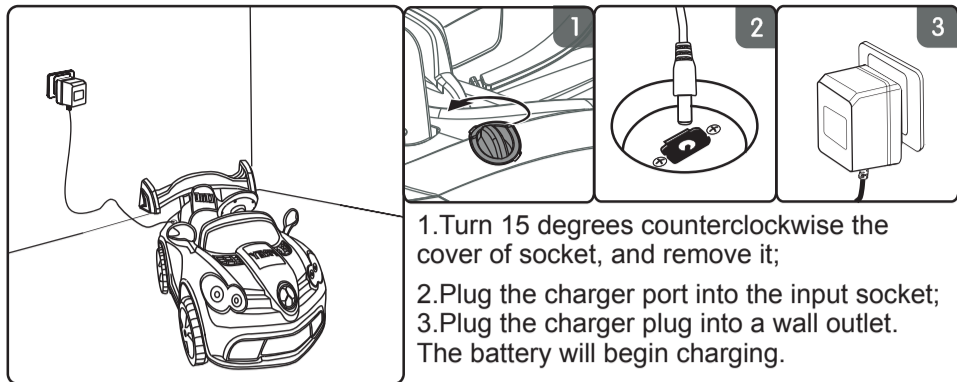

1. Turn 15 degrees counterclockwise the cover of socket, and remove it;
2. Plug the charger port into the input socket;
3. Plug the charger plug into a wall outlet. The battery will begin charging.

Caring For Your Vehicle

- Vehicle body is molded by polypropylene. Solarize or in -15°C use are strictly prohibited. Vehicles should be far away from hot objects, like an oven and heater, plastic parts may melt beside.
- Avoid operating the vehicle in wet or snowy conditions. Do not wash the vehicle with soap and water. Water or moisture in the motors or electrical switches can cause them to corrode and could cause switch or motor failure.
- Avoid operating the vehicle on sand, loose dirt or gravel. Sand, loose dirt or gravel in the motors or electrical switches can cause them to jam, and could cause switch or motor failure.
- The vehicle can be wiped down with a soft, dry cloth for a shiny finish, you can wipe plastic parts with a non-wax furniture polish applied to a soft-cloth. Do not use automotive wax. Do not use soap and water or spray the vehicle with a hose.
- Do not modify the electric system. When the fault appears and they must be maintained by professional. Alterations could cause a fire resulting in serious injury and could also ruin the electrical system.
- Use for about half month, check the wheels turning agilely or not, motor work is normal or not. Also infuse lube to lubricate moving parts.

Problems And Solutions Guide

Question 1: vehicle does not run

- Reason: battery lack of electricity  
After riding each time, please recharge it timely. Must recharge it one time one month at least. Please charge 8-12 hours, but not more than 18 hours.

Parts List

Please identify all parts before assembly and save all packaging materials until assembly is complete to ensure that no parts are discarded.

|                  |                   |                     |
|------------------|-------------------|---------------------|
|                  |                   |                     |
| 1 Vehicle Body   | 2 Wind Frame      | 3 Rearview Mirror   |
|                  |                   |                     |
| 4 Steering Wheel | 5 Seat            | 6 Back Empennage    |
|                  |                   |                     |
| 7 Wheel -4       | 8 Wheel Cup-4     | 9 Accessory Package |
|                  |                   |                     |
| 10 Motor         | 11 Directionlever | 12 Rear Axle        |
|                  |                   |                     |
| 13 Charger       | 14 Remote Control | 15 Guide Book       |

Assembly Steps

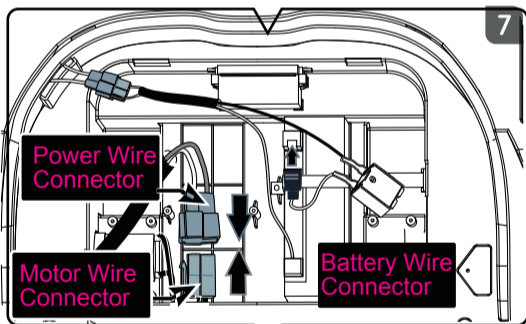

7 Connect the Power Supply

- Plug the power wire connector into the motor wire connector.
- Plug the red power wire connector into the terminal on battery red side as shown.

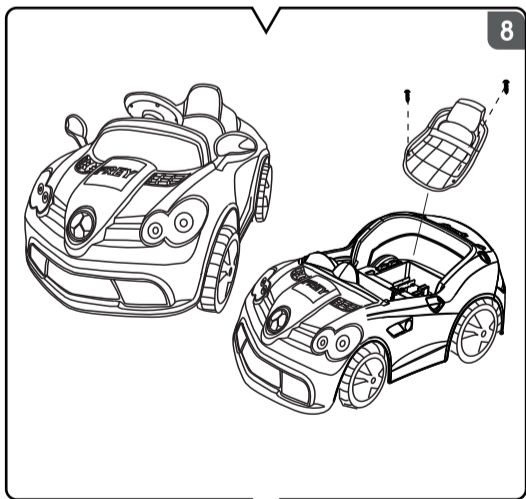

8 Seat Assembly

- Remove two screws from the vehicle body which should fit the seat place.
- Fit the seat cover into the vehicle body, insert with just two screws into it and tighten.

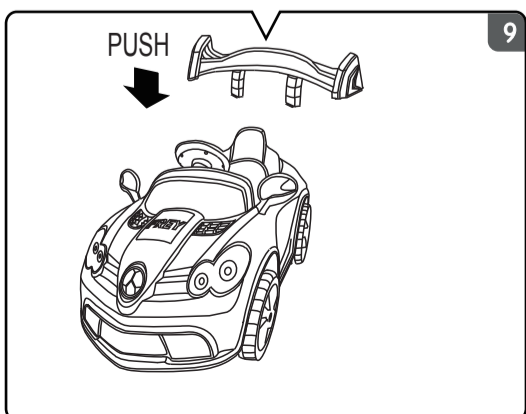

9 Back Empennage Assembly

- Put the back empennage to the back of the vehicle relevant position. When hearing clicking sound, mean been in place.

Assembly Steps

Note:

- 1 Loosen the two screws in the seat cover position of vehicle body. Unplug the wire connector from the gear box connector, take out motor and charger.
- 2 When in assembling any wheel to the axles, we provide two gaskets. Please decide whether to increase gaskets to adjust tightness degree of the wheels free to turn.

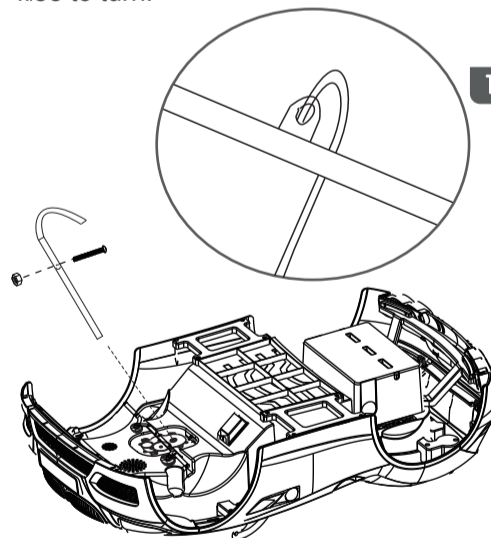

1 Front Axle Assembly

- Turn the vehicle body over
- 1. Insert directionlever into the white hole in the gear motor;
- 2. Make the directionlever pass through the instrument panel.
- Use M4\*22 round screws fix the gear motor tightly. (directionlever and gear motor both have holes.)

(Note: the order before and after the front axle)

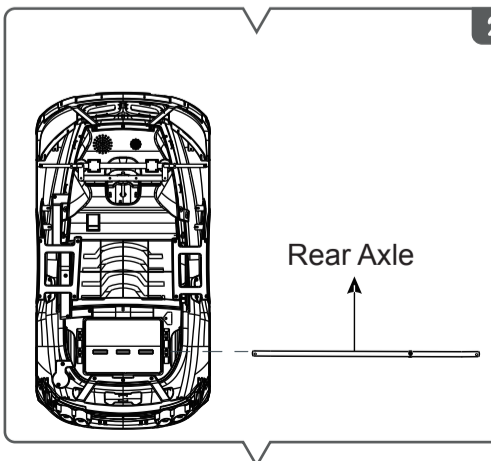

2 Rear Axle Assembly

- With pliers under the split pin from rear axle, take down washers, bushing.
- Insert the rear axle through from right to left the hole in the back of the vehicle body.