

## **Instruction for installation and use of baby carrier**

**Model number:WXE-1688**

**STANDARDS: EN71;EN62115;2005/84/EC**



- The assembling and recharging process should be performed by adults.

Please read this directions carefully before assembling and using. After reading, please keep it carefully for possible future use.

●●●●● ————— ●●●●●

The buggy highly resemble the novel, reasonable shape of the motorcycle. It is handy and equipped with both sound&light system. We sincerely hope our production could bring happiness to both your children your family.

|  |   |
|--|---|
| Specification                                      |   |
| power supply                                       | 2*12V10AH   |
| motor  | 4*45W RS550PH-12V   |
| charger  | Input: AC220V-240V 50HZ-60HZ<br>Output:BC12V 1A 6V.4 5AH FD390-6V |
| Load limit   | 30KG  |
| Usage time   | After charging power 1-2H   |
| speed  | 3-3.5km/H   |
| Age limit  | 37-95months   |
| Remote control distance/<br>Remote control battery | 15+-5M/AAA1.5*2   |
| Box size   | 143*69*42cm   |
| Product size                                       | 145*75*80cm   |

## Matters need attention when charging

- Before the firsts use of the car, make sure the battery has been charged more than 4-6 hours. Or the battery would be damaged permanently and cannot be repaired. ( The charging process has to be operated by adults.)
- When the battery is low, please charge it in time. Normally the charging hour is 8-12 hours, but do not charge it more than 15 hours.
- It is normal that the battery jar emits heat(beyond 60 centigrade), but when the temperature is too high, you should examine whether the recharging process is short-current.
- Only chargers and battery equipped by this car can be used. Chargers and battery jars of other brand are strictly prohibited. Or the charger and battery might be damaged.
- When charging, please turn of the battery. Put the charger plug into the charging hole before plug it on the socket. The car cannot be operated when charging.
- Do not join the two electrodes of the storage battery.
- Keep the packing bag carefully after installation. Keep away from children. Danger for asphyxia.
- When the product is packed away or will not be used for a long time, you have to fully charge the battery and charge it once every month to guarantee the life of the battery.
- The charger and the battery are not toy. Children should not be allowed to play with them.

## Exploded view

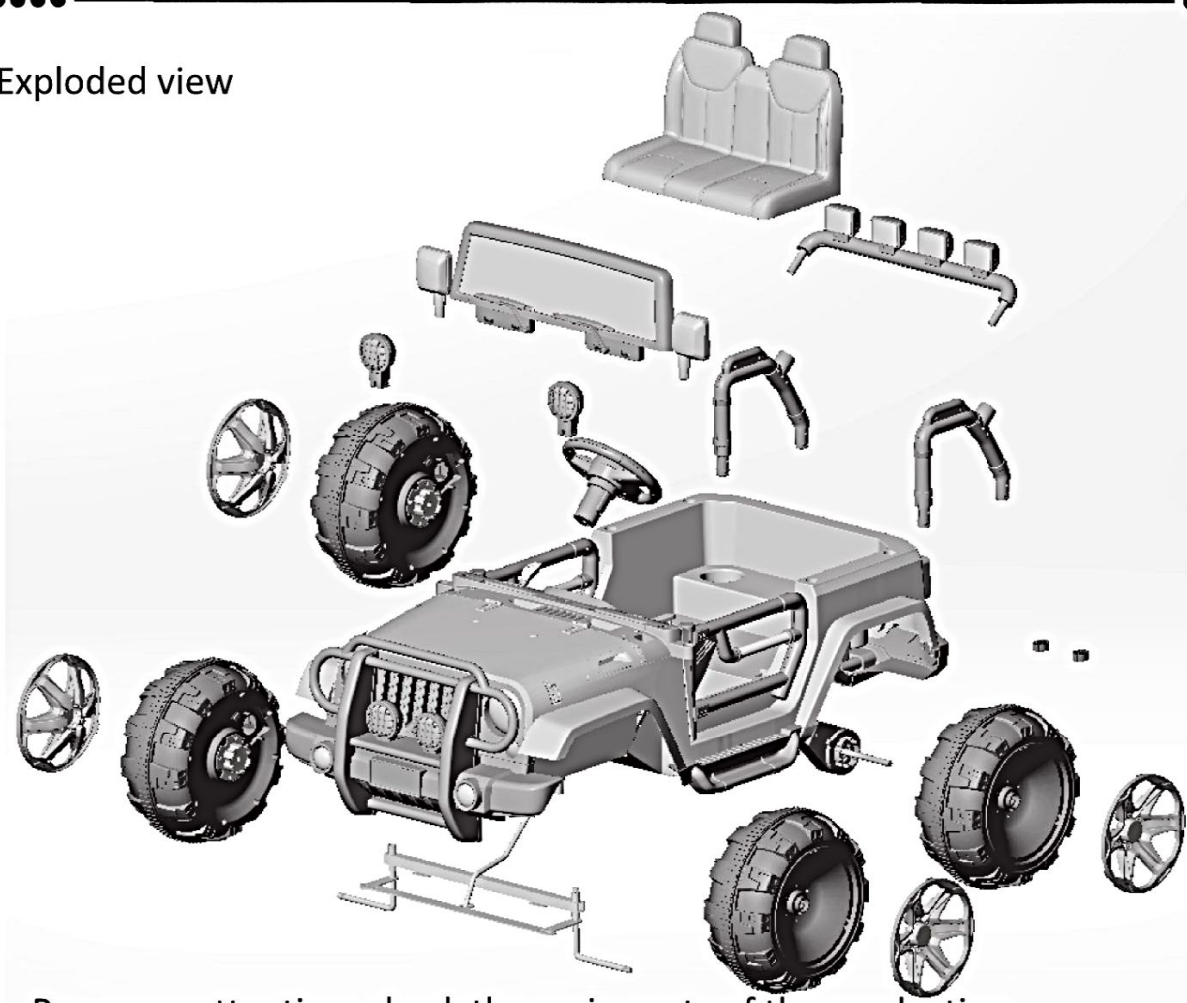

Pay more attention: check the main parts of the production

### Safety rules

#### Warn!

The production could serve as transportation, the child should receive safety education before using the car and should be look after by an adult.

1:Keep away from children under 36 months

2:The recharging process should be performed by adults and keep away from children.

3: T he child should be accompanied by adult while driving

4: Do not block the way of the car.

5: Before use, please check whether all the part are installed well to position and connected tightly.

6: Only chargers and battery equipped by this car can be used.

7: Do not join the two electrodes of the storage battery.

8: Do not use it on smooth surfaces like marbles, floor tiles and glasses.

9: Do not change the structure, line and additional electrical devices without permission.

10: When the car is not used, please switch off the electric power source; when not used for a long time, pluck off the attaching plug.

11: Examine the product and charger regularly to see whether the parts are becoming old or dropped off. When damage is found, the product should be stopped using until fixed.

Wear-resisting ring

Wear-resisting ring

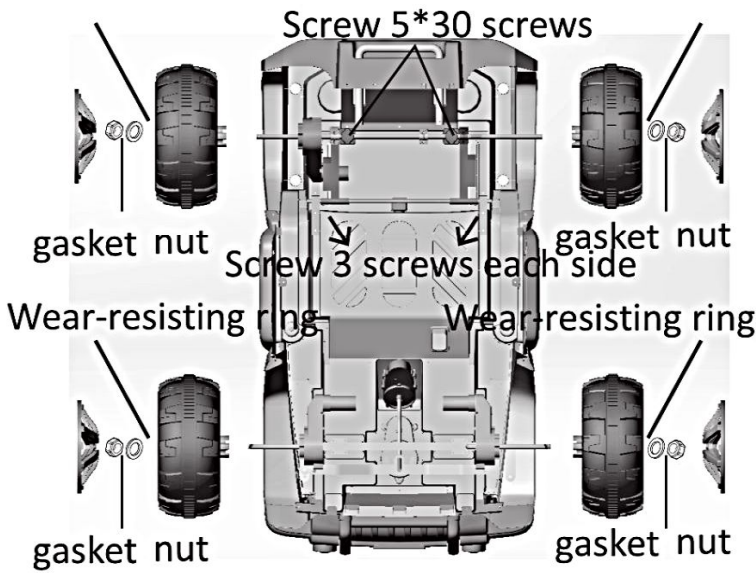

### Installing wheel:

Put the driving gear box into the back-shaft from the left of the car. After putting in the driving wheel, make sure it fit the driving gear box. Use the vice to put the cotter pin through the hole on the back-shaft and make it unable to move. Aim the buckle on the wheel cap at the neck on the wheel and push it down until you hear the click sound. It means the buckle has been installed in place.



### Installing steering wheel:

Connect the lead plug-in on the steering wheel to that of the open holes, and plug the steering wheel in to the end of the steering tube. Pay attention that the plug-in is along the hole.



### Installing windshield frame and view mirror

Put the bayonet into the corresponding net. When hearing the "click" sound, the bayonet is in place. Press view mirrors down until hear the click sound which shows they have been installed in place



### Installing lantern support:

Plug the lantern support in the hole on the two side. Press them down until hear the click sound which shows they have been installed in place



### Installing the cushion

Snap the buckle on the back of the cushion into the neck. The assembling process before using has to be operated by adults.

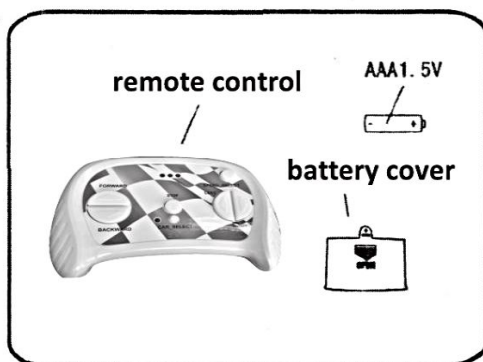

### Installation of remote control battery

The remote control use 2 AAA 1.5V batteries in PRC. Use screw driver to screw off the battery cover and pull it off. Put in 2 AAA 1.5V batteries rightly and put on the battery cover.

## **Charging:**

- Charging seat is under the cushion;
- When open the tank cover on the charging seat, plug in on the jack of the charging seat;
- Plug in the charging seat on the electricity power.

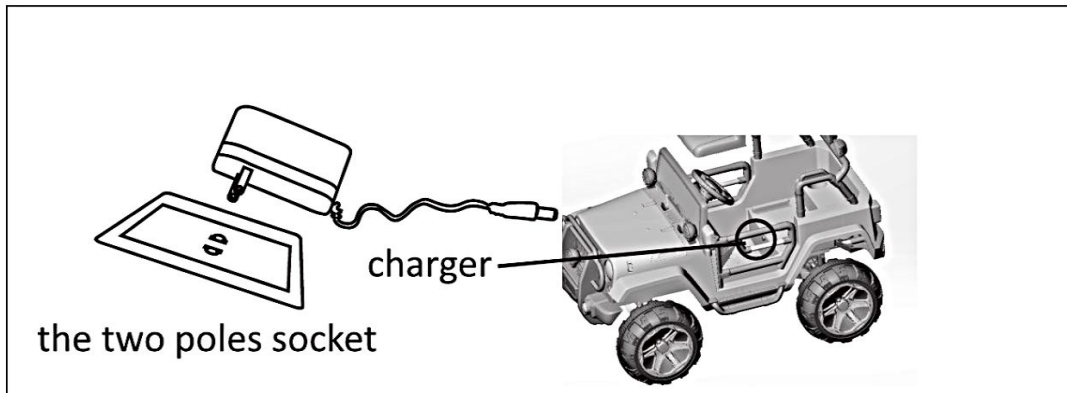

## **Warning!**

- 1: Keep children away under 36 months
- 2: Keep the packing bag carefully after installation. Keep away from children. Danger for asphyxia!
- 3: Remember to keep the instruction for further reference.

### **Attention of remote control**

- 1: Do not Switch the for-backward to forward when moving in order to prevent the motor
- 2: Install battery into remote control before using the baby carrier
- 3: Set remote control function carefully before using it
- 4: Battery charging process should be performed by adults.

## **Battery warning:**

- New/old and different kinds of batteries cannot be used together;
- Positive and negative poles short circuit is strictly prohibited;
- Non-rechargeable batteries cannot be recharged;
- Rechargeable batteries should be taken out before recharging;
- Batteries can only be interposed in right poses;
- Rechargeable batteries should only be charged by adults;
- Used-off batteries should be taken out of the toy and dealt properly to prevent kid's playing;

### **Change the battery:**

use screw driver to screw off the battery cover and pull it off. Put in 3 AA batteries rightly and put on the battery cover.

## Simple Maintenance

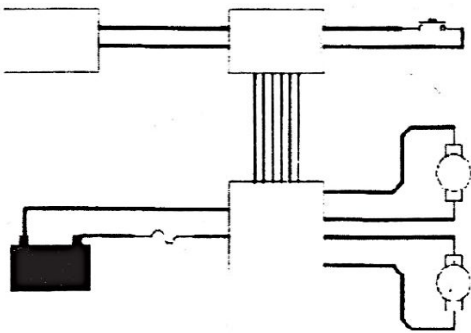
| Fault type                                    | Reason analysis   | Exclusion methods  |
|---|---|--|
| Car's not moving                              | <ol style="list-style-type: none"> <li>1. Battery has low voltage</li> <li>2. Fuse protection</li> <li>3. The nut of the wheel is dropped off</li> <li>4. Socket connector of the battery has fallen off</li> <li>5. Battery is flat</li> <li>6. Electrical damage</li> <li>7. Motor is broken</li> </ol> | <ol style="list-style-type: none"> <li>1. Recharging the battery</li> <li>2. Stop for several minutes before using again</li> <li>3. Screw the nut on</li> <li>4. Link it up again</li> <li>5. Change a new battery</li> <li>6. Go to the maintenance area</li> <li>7. Go to the maintenance area</li> </ol> |
| Low speed                                     | <ol style="list-style-type: none"> <li>1. Battery is old</li> <li>2. Dead battery</li> <li>3. Overload</li> <li>4. Pavement irregularity</li> <li>5. Battery is not charging</li> </ol>   | <ol style="list-style-type: none"> <li>1. Change a new battery</li> <li>2. Recharging the battery</li> <li>3. Reduce weight bearing to below 30kg</li> <li>4. Ride on smooth-riding surface</li> <li>5. Recharging the battery</li> </ol>  |
| Battery cannot be recharged                   | <ol style="list-style-type: none"> <li>1. socket connector of the battery has fallen off</li> <li>2. there's no power</li> <li>3. charger is damaged</li> </ol>   | <ol style="list-style-type: none"> <li>1. link it up again</li> <li>2. plug it in</li> <li>3. replace a new charger</li> </ol>   |
| Short flight mileage                          | <ol style="list-style-type: none"> <li>1. Battery off</li> <li>2. Battery is old</li> </ol>   | <ol style="list-style-type: none"> <li>1. Recharging the battery</li> <li>2. Change a new battery</li> </ol>   |
| Car is shaking when progressing               | <ol style="list-style-type: none"> <li>1. Connector cable for lens motor contact poorly</li> <li>2. There's dead spot on the motor</li> </ol>   | <ol style="list-style-type: none"> <li>1. Reconnect it</li> <li>2. Repair it in maintenance point</li> </ol>   |
| There's slight sound and heat when recharging | <ol style="list-style-type: none"> <li>1. This belongs to normal chemical reaction</li> <li>2. Gear is broken</li> </ol>  | <ol style="list-style-type: none"> <li>1. It's normal</li> <li>2. Repair it in maintenance</li> </ol>  |
| Circuit diagram                               |   |  |

## **Matters needing attention**

1. The product should be assembled correctly by adults before usage.
2. Keep away from children under three.
3. Battery charging process should be performed by adults.
4. Ensure a ten-hour-long battery charging process before the first use, otherwise the battery will suffer permanent damage.
5. Keep away from dangerous areas like street/road/slippery areas etc.
6. For one person weighting less than 30kg only.
7. Make sure the safety belt fastened and the child seated. Dangerous actions as well as standing up are forbidden.
8. Do not press the forward/back button abruptly while driving.
9. Do not drive in narrow space, in order to avoid damage to the product.
10. Go on Pull out the battery during the long period without use.
11. The product should be used with adult guardianship.
12. Safe period for use: 3 years