

Install the remote control battery

Firstly, buy two AA1.5V batteries, remove the screws from the remote control, then open the cover, put the batteries(please take care the positive and negative mark), finally put on the cover, tighten the screw (as picture 11)

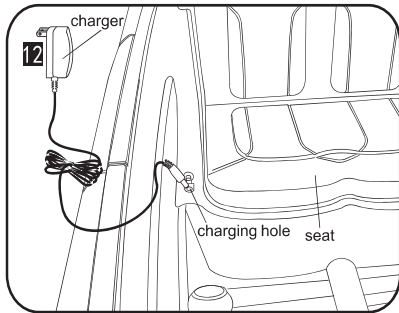

Charge the Battery

Once charging, open the charging cover, insert the charger to the charging hole, then put the charger to the power, charge 8-10 hours.
Note: On charging the vehicle without any functions (as picture12)

Charge Caution

- Firstly using the vehicle, must charge fully the battery. Insert the end of charger into the charge hole, then plug the charger port into the input socket.(charge must done by adult, do not let your children to touch them.)
- When the vehicle drives slowly, please charge on time, and continuous charging8-10 hours, cannot exceed 10 hours.
- It is normal case the charger or battery become hot(below 60°C) during charging.
- On charging, check the wire connection whether is correct, the indicator lighter whether is bright.
- On charging, the vehicle without any functions, could not operate.
- Please using the charger and battery which with this vehicle, in case of hurting the charger, the battery or other electric lines.
- Could not use another charger into this product charging.
- Could not mix the new ,the old or different type batteries together.
- Charge battery must be done by adult.
- Charge the battery once per month, even if the vehicle has not been used.
- Should remove the exhausted battery from the vehicle.
- Could not short-circuit power terminals.
- Non- rechargeable batteries are not to be recharge
- Rechargeable batteries are not to be remove from the toy before being charged
- Batteries are to be inserted with the correct polarity

Installation Instructions

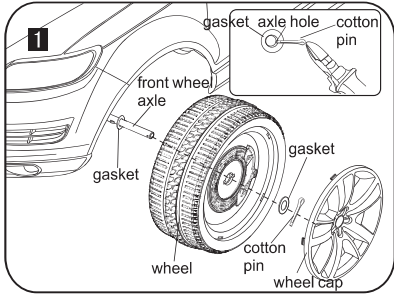

Front Wheel Assembly

Take out the screw package, according to picture at left. Put gasket, front wheel (without connect one), gasket into front axle, then put cotton pin to shaft hole, and make it to “M” shape by plier. Finally put the wheel cap

(as picture 1)

Notice: left and right side are same assembly way.

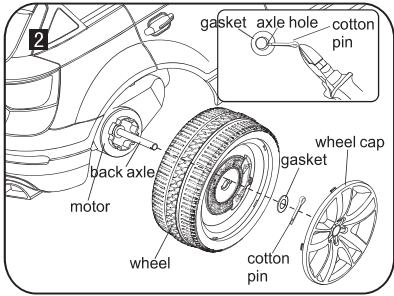

Back Wheel Assembly

Firstly, put the motor into the back axle according to picture at left, then back wheel (with connect one), make the motor connect with the wheel together, then put the gasket into back axle, insert the cotton pin to shaft hole, and make it to “M” shape by plier. Finally put the wheel cap

(as picture 2)

Notice: left and right side are same assembly way.

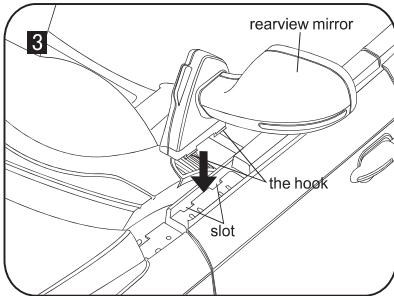

Rearview Mirror Assembly

Press the rearview mirror into the right place, it is not done until hear a “crack”.

(as picture 3)

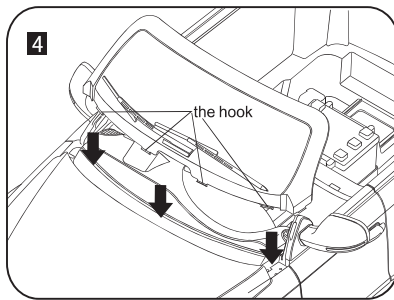

Wind Frame Assembly

Remove the wind frame, put the hook to aim to slot, press the wind frame into the right place, until hearing a “crack” . Check all the hooks assembly again at last.
(as picture 4)

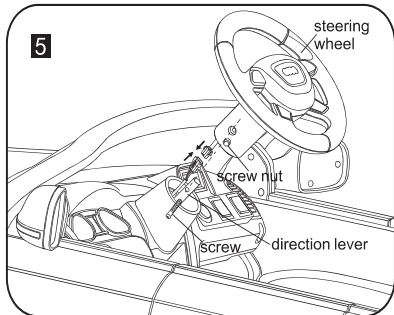

Steering Wheel Assembly

Remove the steering wheel, connect the wire from the steering wheel together with the direction lever's wire, then insert the steering wheel into the direction lever, to make the hole to same line, then put on screw and nut, tighten them.

(as picture 5)

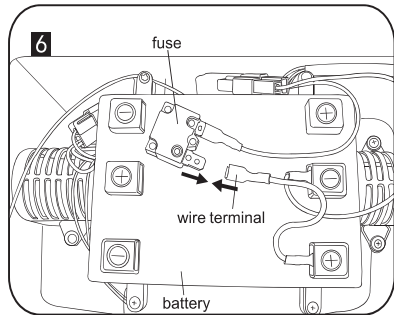

Connecting Battery Line

Insert the wire terminal to the fuse, check other electric wire together connect well, if OK, connect the battery line.

(as picture 6)

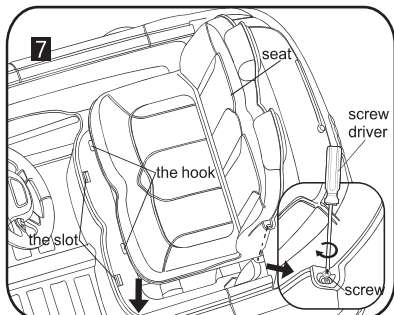

Seat Assembly

Remove the seat, and collect the seat belt, press the seat into the right place, then using the screwdriver to tight the screw on the seat.

(as picture 7)

Notice: when remove the seat, just reverse the order.

Function Instructions

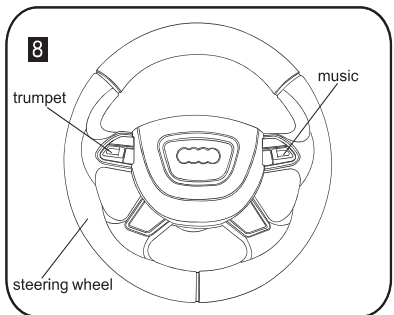

Steering Wheel Using Instrument

Like real car steering wheel, flexible operation, press the button can switch to different music. The left side is “the trumpet”; the right side is music

(as picture 8)

Note: when use these function, the car must be with power, when press the music button, can switch some music with the colorful light, increasing riding fun.

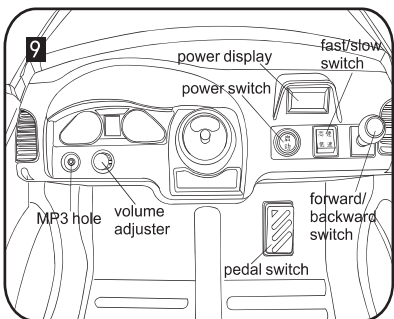

Function Using

- 1.Open the power switch, the light open. Press the forward button, tread the pedal, the car will move forward, press the back button, tread the pedal, the car will move back, press the middle button, the car will stop.
- 2.Adjust the volume adjuster as you like.
- 3.Provide the MP3 line ,can connect with MP3 machine to listen to music.
- 4.Provide power display, can show the power volume at any time, once short of, can recharge in time,
- 5.Provide two speeds, can switch fast or low speed.

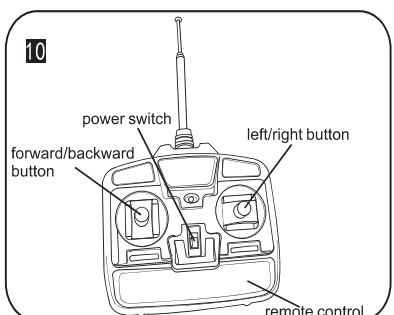

Remote Control Operation

When ride on the vehicle, open the power switch to “ON” place , push the “forward/backward button” to the front or back, the vehicle goes forward or back; push the “left or right, to the left or right, the vehicle turns left or right.